



*Your Complete Piping Solutions*

# PVC-U

## Rainwater Drainage System





# COMPANY BACKGROUND

Cew Sin Plastic Pipe (243310-M) was founded in 1992 and is a renowned plastic pipe manufacturer in Malaysia that specializes in Unplasticized Polyvinyl Chloride (PVC-U) Pipes and Fittings, Polypropylene Random (PP-R) Pipes and Fittings and High-Density Polyethylene (HDPE) Pipes. Cew Sin (CS) uses primarily PVC-U, PP-R and HDPE raw materials to manufacture high-quality, safe and reliable plastic pipes and fittings for a wide range of applications, including water supply, drainage, sewage, cable and wire conduits for a wide spectrum of industries such as construction, infrastructure, utility, agriculture and many more. It is our cutting-edge technology and proven track record of quality excellence that has made us a respected leader in the market.

CS is also committed to providing green solutions for our customers. We offer environmentally friendly, lead-free options for our pipes and fittings. Our products also comply with various national and international professional certifications as part of our pursuit of quality excellence. At the same time, we invest heavily in Research and Development because we believe in continuously upgrading the quality of our products, as befitting our status as a market leader in Malaysia.

We owe our achievements in the plastic pipe manufacturing industry to sound management, professional production, continuous upgrades and efficient services. Our endeavours over the years have made us a well-trusted brand in both the domestic and international market.

We are ISO 9001:2015 Quality Management System certified, while stringent measures are adopted to ensure a high product quality that meets our local and export customers' needs. Our products are also endorsed by SIRIM QAS (Standard of Industrial and Research Institute in Malaysia) and TÜV SÜD certified according to local and international standards.

Apart from international certification, our pipes and fittings meet the requirements of the Malaysian National Water Authority (Suruhanjaya Perkhidmatan Air Negara or SPAN), Jabatan Air Negeri Sabah, and the State Water Authority of Sarawak.

**2**

---

**Company Background**

**4**

---

**Vision, Mission and Quality Policy**

**6**

---

**Introduction and Product Code**

**8**

---

**PVC-U Rainwater Down Pipes  
Product Feature and Information**

**10**

---

**PVC-U Rainwater & SWV Fittings  
Product Size and Dimension**

**23**

---

**PVC-U Rainwater Drainage  
Assembly System**

**25**

---

**Installation Guide**

**27**

---

**Other Catalogues**

**THE  
NEW  
TITAN  
CON**





## OUR COMMITMENTS AND SERVICES

### VISION

To become the leading manufacturer and distributor of complete PVC-U, PP-R and HDPE pipping systems in the region.

### MISSION

To ensure total customer satisfaction through continuously improving our products, resources, facilities and services.

### QUALITY POLICIES

- ◆ Customer satisfaction is our top priority
- ◆ Strive to be the best in the industry
- ◆ People competency is the key driver
- ◆ Plan for and commit to continuous improvement



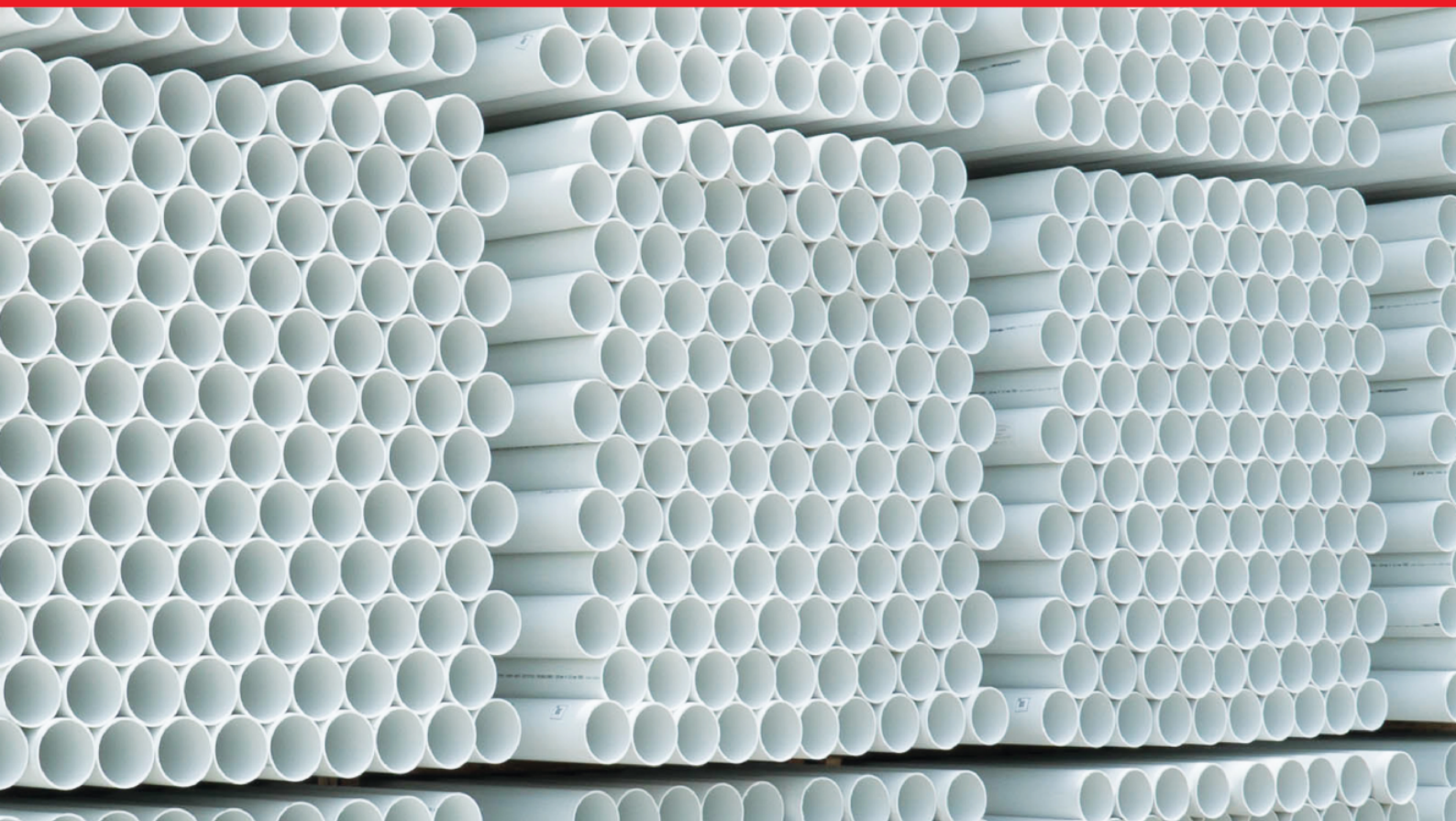

## STATE-OF-THE-ART LABORATORY

CS strongly believes in the importance of high-quality, durable, safe and reliable products. We have a comprehensive range of equipment in our laboratory where all products are rigorously tested in compliance with local and international standards. Fine raw materials and compounds are assessed in terms of temperature, pressure and energy input, while pipe samples are put under stringent impact and tensile strength inspections. Our dedicated Research and Development team is also always working on developing new ways to upgrade the quality of our pipes and fittings as according to industry standards.

## OFFICIAL CERTIFICATIONS

CS's wide range of products adheres to ISO 9001 certification, as well as both local and international standards, including but not limited to:

- ♦ SIRIM (Standard and Industrial Research Institute of Malaysia)
- ♦ TÜV SÜD Malaysia



# PVC-U PIPES: RAINWATER AND SOIL, WASTE, VENT PIPES AND FITTINGS

This range of PVC-U pipes is recommended for its strong endurance to weathering effects and high resistance to corrosion. All pipes in this range are rigorously tested to adhere to local and international standards for soil, ventilation and waste discharge inside buildings, in the ground and within the building structure. All pipes are manufactured from high-quality PVC-U resin and compounds for a reliable, safe, durable and superior product.

## Features:

- ◆ Recommended for internal plumbing and construction projects
- ◆ Superior resistance to chemical corrosion ensures long lifespan
- ◆ Low maintenance due to high abrasion resistance
- ◆ Strong endurance to weathering effects
- ◆ Rigorously tested according to local and international standards
- ◆ Appropriate for use inside buildings, in the ground and within the building structure
- ◆ Durable, reliable and safe
- ◆ Only available in white colour

## CS Pipe Marking

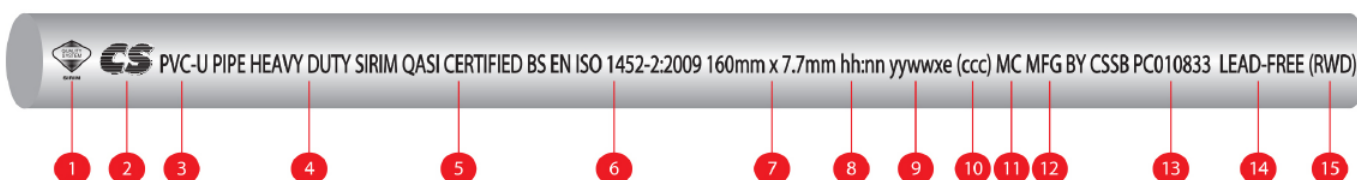

- |  |   |
|--|---|
| 1 SIRIM Logo    | 9 Production code (yy-year/ww-weeks/x-day of weeks/e-shift) |
| 2 CEW SIN Logo  | 10 Counter Batch  |
| 3 Material   | 11 Machine no.  |
| 4 Application  | 12 Manufacture Code   |
| 5 Certification Body   | 13 Sirim License Number                                     |
| 6 Standard References and Conformance  | 14 LEAD-FREE Formulation                                    |
| 7 Nominal Size & Wall Thickness  | 15 Rainwater Drainage System                                |
| 8 Time and Minutes   |   |

# PRODUCT CODE

## PVC-U PIPE NEW CODE

**PS-RWHD-160-5.8-WT**

GROUP+  
SERIES

PRODUCT &  
CLASS

DIAMETER  
SIZES

LENGTH

COLOUR

## PVC-U FITTINGS NEW CODE

**F-SB-160-WT**

GROUP+  
SERIES

PRODUCT

DIAMETER  
SIZES

COLOUR

### GROUP

|   |          |
|---|----------|
| P | PIPE     |
| F | FITTINGS |
| O | OTHERS   |

### SERIES

|   |             |
|---|-------------|
| S | SIRIM       |
| C | CUSTOM MADE |

### PRODUCT & CLASS

|      |                             |
|------|-----------------------------|
| RWLD | RAIN WATER DOWN LIGHT DUTY  |
| RWND | RAIN WATER DOWN NORMAL DUTY |
| RWMD | RAIN WATER DOWN MEDIUM DUTY |
| RWHD | RAIN WATER DOWN HEAVY DUTY  |

### FITTINGS

|        |                                 |
|--------|---------------------------------|
| SB     | SWEPT BEND                      |
| SBIO   | SWEPT BEND WITH I/O             |
| B135   | BEND PLAIN 135°                 |
| B135IO | BEND PLAIN 135° WITH I/O        |
| B68    | BEND PLAIN 112° / 68°           |
| B68IO  | BEND PLAIN 112° / 68° WITH I/O  |
| BB     | BOSSSED BEND [M/F]              |
| BBIO   | BOSSSED BEND WITH I/O [M/F]     |
| RB90   | REDUCING BEND 90°               |
| ESB    | EQUAL SINGLE BRANCH             |
| ESBIO  | EQUAL SINGLE BRANCH WITH I/O    |
| RSB    | REDUCING SINGLE BRANCH          |
| RSBIO  | REDUCING SINGLE BRANCH WITH I/O |
| YB135  | Y-BRANCH 135°                   |
| RYB135 | REDUCING Y-BRANCH 135°          |
| CT     | CROSS TEE 90° [F/F]             |
| RCT    | REDUCING CROSS TEE 90° [F/F]    |
| BC     | BOSS CONNECTOR                  |
| SC     | STRAIGHT COUPLING               |
| LIRS   | LEVEL INVERT REDUCING SOCKET    |
| CRS    | CONCENTRIC REDUCING SOCKET      |
| PS     | PIPE SLEEVE                     |
| RB     | BUSH / SOCKET REDUCER           |
| FLG    | FLANGE                          |
| UB     | U-BODY                          |
| SWN    | SWAN NECK                       |
| EC     | END CAP                         |
| FGGS   | FLOOR GULLY GRATING SET         |
| API    | ACCESS PLUG INSERT              |
| APS    | ACCESS PLUG SOCKET              |

|        |                              |
|--------|------------------------------|
| HDSB   | HEAVY DUTY SWEPT BEND        |
| HDB135 | HEAVY DUTY BEND 135°         |
| HDSC   | HEAVY DUTY STRAIGHT COUPLING |
| FGIO   | FLOOR GULLY WITH TRAP I/O    |
| VC     | VENT COWL                    |
| DG     | DOME FILTER / GRATING        |

### DIAMETER / SIZES

|       |        |
|-------|--------|
| 36MM  | 1 1/4" |
| 43MM  | 1 1/2" |
| 56MM  | 2"     |
| 82MM  | 3"     |
| 110MM | 4"     |
| 160MM | 6"     |
| 200MM | 8"     |
| 250MM | 10"    |
| 315MM | 12"    |

### LENGTH

|     |         |
|-----|---------|
| 4.0 | 4.0 MTR |
| 5.8 | 5.8 MTR |
| 6.0 | 6.0 MTR |

### COLOR

|    |       |
|----|-------|
| WT | WHITE |
|----|-------|



# PVC-U RAINWATER DOWN PIPES

**BS EN 12200 – 1:2016**

(BS 4576)



CS's Rainwater Down Pipes are the ideal solution for high rainfall countries like Malaysia. Made of high-quality PVC-U resins and compounds, these pipes are durable, sustainable, safe and reliable. They are lightweight and easy to transport and install, but also resilient to weathering effects even in harsh climates. They are recommended for a wide variety of applications including residential, commercial and industrial sectors. CS's Rainwater Down Pipes are available in 4 ranges – light duty, normal duty, medium duty and heavy duty.

## **Features:**

- ◆ Ideal solution for high rainfall countries
- ◆ Recommended storm-water control system
- ◆ Suitable for heavy-duty construction projects
- ◆ Able to withstand heavy duty utilization
- ◆ Superior resistance to chemical corrosion ensures long lifespan
- ◆ Low maintenance due to high abrasion resistance
- ◆ Strong endurance to weathering effects
- ◆ Rigorously tested according to local and international standards
- ◆ Recommended for residential, commercial and industrial sectors
- ◆ Lightweight and easy to handle, transport and install

## **APPLICATION OF EACH RAINWATER DOWN PIPES**

### **Light Duty**

- ◆ Suitable for exposed installation only
- ◆ Recommended for landed properties such as terrace houses or bungalows

### **Normal Duty**

- ◆ Suitable for installation above and below ground, inside and outside buildings, fixed on the wall or buried building structures
- ◆ Recommended for residential, commercial and industrial use

### **Medium Duty**

- ◆ Suitable for exposed installation and casting in small Reinforced Concrete (RC) columns or piers
- ◆ Recommended for high rise properties such as apartments, condominiums and commercial buildings

### **Heavy Duty**

- ◆ Suitable for casting in Reinforced Concrete (RC) columns, piers, pillars, and buried underground
- ◆ Recommended for high rise buildings and mega construction projects such as bridges and overpasses

**LIGHT DUTY - Conformance Standard BS EN 12200 - 1:2016**

| PRODUCT CODE       | NOMINAL/SIZES |      | OUTSIDE DIAMETER (MM) |        | MIN WALL THICKNESS | LENGTH (METER) |
|--------------------|---------------|------|-----------------------|--------|--------------------|----------------|
|                    | (IN.)         | (MM) | MIN                   | MAX    |                    |                |
| PS-RWLD-082-5.8-WT | 3             | 82   | 82.40                 | 82.80  | 1.8                | 5.8            |
| PS-RWLD-110-5.8-WT | 4             | 110  | 110.00                | 110.40 | 2.2                | 5.8            |
| PS-RWLD-160-5.8-WT | 6             | 160  | 160.00                | 160.60 | 3.2                | 5.8            |
| PS-RWLD-200-5.8-WT | 8             | 200  | 200.00                | 200.60 | 3.9                | 5.8            |
| PS-RWLD-250-5.8-WT | 10            | 250  | 250.00                | 250.70 | 4.9                | 5.8            |
| PS-RWLD-315-5.8-WT | 12            | 315  | 315.00                | 315.90 | 6.2                | 5.8            |

**NORMAL DUTY / Code BD Conformance Standard MS 1063: 2002 (BS 4514, BS4660, BS5481)**

| PRODUCT CODE       | NOMINAL/SIZES |      | OUTSIDE DIAMETER (MM) |        | WALL THICKNESS (MM) |      | LENGTH (METER) |
|--------------------|---------------|------|-----------------------|--------|---------------------|------|----------------|
|                    | (IN.)         | (MM) | MIN                   | MAX    | MIN                 | MAX  |                |
| PS-W-082-BD-5.8-WT | 3             | 82   | 82.40                 | 82.80  | 3.00                | 3.50 | 5.8            |
| PS-W-110-BD-5.8-WT | 4             | 110  | 110.00                | 110.30 | 3.20                | 3.80 | 5.8            |
| PS-W-160-BD-5.8-WT | 6             | 160  | 160.00                | 160.40 | 4.00                | 4.60 | 5.8            |
| PS-W-200-BD-5.8-WT | 8             | 200  | 200.00                | 200.50 | 4.90                | 5.60 | 5.8            |
| PS-W-250-BD-5.8-WT | 10            | 250  | 250.00                | 250.50 | 6.20                | 7.10 | 5.8            |
| PS-W-315-BD-5.8-WT | 12            | 315  | 315.00                | 315.60 | 7.70                | 8.70 | 5.8            |

Code "BD" = Application area code for components intended for above ground use for both inside the buildings or components outside buildings fixed onto the wall and buried in building structures.

**MEDIUM DUTY - For exposed & casting in the small size of RC column. Conformance Standard BS EN ISO 1452 - 2:2009**

| PRODUCT CODE       | NOMINAL/SIZES |      | OUTSIDE DIAMETER (MM) |        | MIN WALL THICKNESS | LENGTH (METER) |
|--------------------|---------------|------|-----------------------|--------|--------------------|----------------|
|                    | (IN.)         | (MM) | MIN                   | MAX    |                    |                |
| PS-RWMD-082-5.8-WT | 3             | 82   | 82.40                 | 82.80  | 4.0                | 5.8            |
| PS-RWMD-110-5.8-WT | 4             | 110  | 110.00                | 110.40 | 4.2                | 5.8            |
| PS-RWMD-160-5.8-WT | 6             | 160  | 160.00                | 160.60 | 6.2                | 5.8            |
| PS-RWMD-200-5.8-WT | 8             | 200  | 200.00                | 200.60 | 7.7                | 5.8            |
| PS-RWMD-250-5.8-WT | 10            | 250  | 250.00                | 250.70 | 9.6                | 5.8            |
| PS-RWMD-315-5.8-WT | 12            | 315  | 315.00                | 316.00 | 12.1               | 5.8            |

The nominal (minimum) wall thickness conform to ISO 1452-2 with working pressure up to 10.0 bar / Class C

**HEAVY DUTY - For casting in the RC Column / underground. Conformance Standard BS EN ISO 1450 - 2:2009**

| PRODUCT CODE       | NOMINAL/SIZES |      | OUTSIDE DIAMETER (MM) |        | MIN WALL THICKNESS | LENGTH (METER) |
|--------------------|---------------|------|-----------------------|--------|--------------------|----------------|
|                    | (IN.)         | (MM) | MIN                   | MAX    |                    |                |
| PS-RWHD-082-5.8-WT | 3             | 82   | 82.40                 | 82.80  | 4.6                | 5.8            |
| PS-RWHD-110-5.8-WT | 4             | 110  | 110.00                | 110.40 | 5.3                | 5.8            |
| PS-RWHD-160-5.8-WT | 6             | 160  | 160.00                | 160.60 | 7.7                | 5.8            |
| PS-RWHD-200-5.8-WT | 8             | 200  | 200.00                | 200.60 | 9.6                | 5.8            |
| PS-RWHD-250-5.8-WT | 10            | 250  | 250.00                | 250.70 | 11.9               | 5.8            |
| PS-RWHD-315-5.8-WT | 12            | 315  | 315.00                | 316.00 | 15.0               | 5.8            |

The nominal (minimum) wall thickness conform to ISO 1452-2 with working pressure up to 12.5 bar / Class D



# PVC-U RAINWATER & SWV FITTINGS

## SWEPT BEND

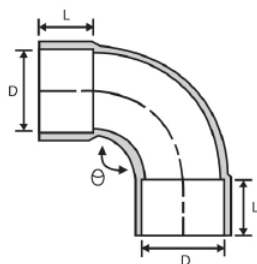

| PRODUCT CODE | NOMINAL SIZE (MM) | DIMENSIONS (MM) |        |        |
|--------------|-------------------|-----------------|--------|--------|
|              |                   | Angle (θ)       | D      | L      |
| F-SB-036-WT  | 36                | 91.50           | 36.30  | 18.00  |
| F-SB-043-WT  | 43                | 91.50           | 42.90  | 21.00  |
| F-SB-056-WT  | 56                | 91.50           | 56.00  | 32.20  |
| F-SB-082-WT  | 82                | 91.50           | 82.80  | 45.00  |
| F-SB-110-WT  | 110               | 91.50           | 110.50 | 52.30  |
| F-SB-160-WT  | 160               | 91.50           | 160.60 | 78.50  |
| F-SB-200-WT  | 200               | 91.50           | 200.70 | 81.60  |
| F-SB-250-WT  | 250               | 91.50           | 250.50 | 82.10  |
| F-SB-315-WT  | 315               | 91.50           | 315.50 | 103.10 |

## SWEPT BEND WITH I/O

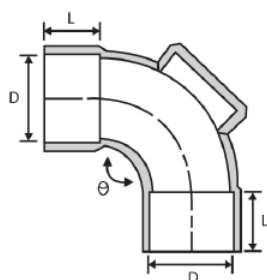

| PRODUCT CODE    | NOMINAL SIZE (MM) | DIMENSIONS (MM) |        |        |
|-----------------|-------------------|-----------------|--------|--------|
|                 |                   | Angle (θ)       | D      | L      |
| F-SBIO-043-WT   | 43                | 91.50           | 43.00  | 21.00  |
| F-SBIO-056-WT   | 56                | 91.50           | 56.10  | 32.00  |
| F-SBIO-082-WT   | 82                | 91.50           | 82.80  | 45.00  |
| F-SBIO-110-WT   | 110               | 91.50           | 110.50 | 52.30  |
| F-SBIO-160-WT   | 160               | 91.50           | 160.60 | 78.50  |
| F-SBIO-200-WT   | 200               | 91.50           | 200.70 | 81.60  |
| F-SBIO-250-WT   | 250               | 91.50           | 250.50 | 82.10  |
| F-C-SBIO-315-WT | 315               | 91.50           | 315.50 | 103.10 |

## BEND PLAIN 135°

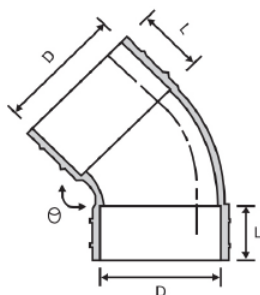

| PRODUCT CODE  | NOMINAL SIZE (MM) | DIMENSIONS (MM) |        |        |
|---------------|-------------------|-----------------|--------|--------|
|               |                   | Angle (θ)       | D      | L      |
| F-B135-036-WT | 36                | 135.00          | 36.40  | 24.00  |
| F-B135-043-WT | 43                | 135.00          | 43.10  | 27.00  |
| F-B135-056-WT | 56                | 135.00          | 56.00  | 30.00  |
| F-B135-082-WT | 82                | 135.00          | 82.80  | 45.50  |
| F-B135-110-WT | 110               | 135.00          | 110.40 | 48.00  |
| F-B135-160-WT | 160               | 135.00          | 160.80 | 77.40  |
| F-B135-200-WT | 200               | 135.00          | 200.40 | 81.10  |
| F-B135-250-WT | 250               | 135.00          | 250.60 | 85.60  |
| F-B135-315-WT | 315               | 135.00          | 315.50 | 100.20 |



# PVC-U RAINWATER & SWV FITTINGS

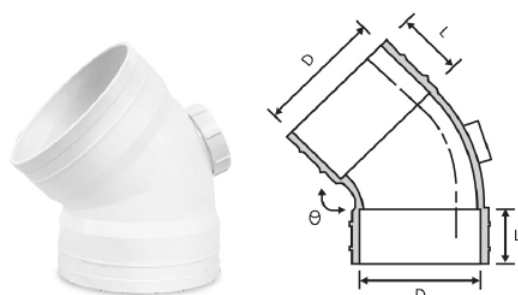

## BEND PLAIN 135° WITH I/O

| PRODUCT CODE      | NOMINAL SIZE (MM) | DIMENSIONS (MM) |        |        |
|-------------------|-------------------|-----------------|--------|--------|
|                   |                   | Angle (θ)       | D      | L      |
| F-C-B135IO-110-WT | 110               | 135.00          | 110.40 | 48.00  |
| F-C-B135IO-160-WT | 160               | 135.00          | 160.50 | 78.00  |
| F-C-B135IO-200-WT | 200               | 135.00          | 200.70 | 80.00  |
| F-B135IO-250-WT   | 250               | 135.00          | 250.60 | 85.60  |
| F-C-B135IO-315-WT | 315               | 135.00          | 315.50 | 100.20 |

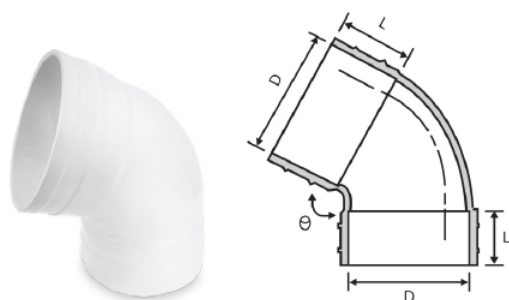

## BEND PLAIN 112° / 68°

| PRODUCT CODE   | NOMINAL SIZE (MM) | DIMENSIONS (MM) |        |        |
|----------------|-------------------|-----------------|--------|--------|
|                |                   | Angle (θ)       | D      | L      |
| F-C-B68-110-WT | 110               | 68.00           | 110.40 | 52.50  |
| F-C-B68-160-WT | 160               | 68.00           | 160.50 | 78.00  |
| F-B68-200-WT   | 200               | 68.00           | 200.60 | 80.20  |
| F-C-B68-250-WT | 250               | 68.00           | 250.70 | 86.00  |
| F-C-B68-315-WT | 315               | 68.00           | 315.20 | 101.70 |

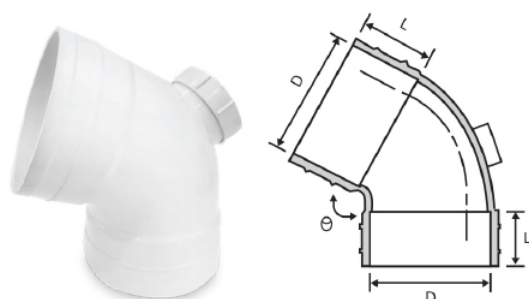

## BEND PLAIN 112° / 68° WITH I/O

| PRODUCT CODE     | NOMINAL SIZE (MM) | DIMENSIONS (MM) |        |        |
|------------------|-------------------|-----------------|--------|--------|
|                  |                   | Angle (θ)       | D      | L      |
| F-C-B68IO-110-WT | 110               | 68.00           | 110.40 | 52.50  |
| F-C-B68IO-160-WT | 160               | 68.00           | 160.50 | 78.00  |
| F-B68IO-200-WT   | 200               | 68.00           | 200.81 | 80.00  |
| F-C-B68IO-250-WT | 250               | 68.00           | 250.70 | 86.00  |
| F-C-B68IO-315-WT | 315               | 68.00           | 315.20 | 101.70 |

# PVC-U RAINWATER & SWV FITTINGS

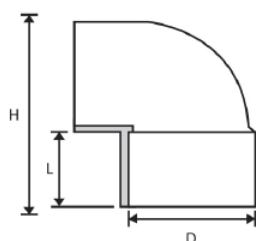

## BOSSED BEND [M/F]

| PRODUCT CODE | NOMINAL SIZE (MM) | DIMENSIONS (MM) |        |       |        |
|--------------|-------------------|-----------------|--------|-------|--------|
|              |                   | Angle (°)       | D      | L     | H      |
| F-BB-110-WT  | 110               | 90.00           | 110.40 | 49.50 | 162.00 |

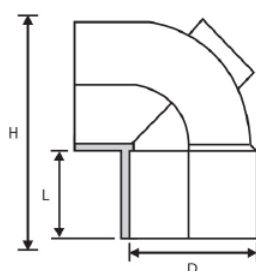

## BOSSED BEND WITH I/O [M/F]

| PRODUCT CODE  | NOMINAL SIZE (MM) | DIMENSIONS (MM) |        |       |        |
|---------------|-------------------|-----------------|--------|-------|--------|
|               |                   | Angle (°)       | D      | L     | H      |
| F-BBIO-110-WT | 110               | 90.00           | 110.40 | 49.50 | 162.00 |

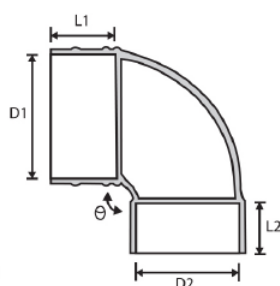

## REDUCING BEND 90°

| PRODUCT CODE      | NOMINAL SIZE (MM) | DIMENSIONS (MM) |        |       |       |       |
|-------------------|-------------------|-----------------|--------|-------|-------|-------|
|                   |                   | Angle (°)       | D1     | D2    | L1    | L2    |
| F-RB90-110X082-WT | 110X82            | 90.00           | 110.50 | 83.00 | 52.40 | 45.00 |

# PVC-U RAINWATER & SWV FITTINGS

## EQUAL SINGLE BRANCH

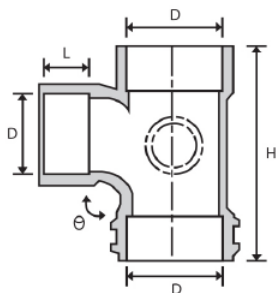

| PRODUCT CODE   | NOMINAL SIZE (MM) | DIMENSIONS (MM) |        |       |        |
|----------------|-------------------|-----------------|--------|-------|--------|
|                |                   | Angle (θ)       | D      | L     | H      |
| F-ESB-036-WT   | 36                | 91.50           | 36.30  | 24.00 | 94.80  |
| F-ESB-043-WT   | 43                | 91.50           | 43.00  | 24.10 | 110.60 |
| F-ESB-056-WT   | 56                | 91.50           | 56.00  | 30.00 | 133.00 |
| F-ESB-082-WT   | 82                | 91.50           | 82.80  | 45.00 | 206.60 |
| F-ESB-110-WT   | 110               | 91.50           | 110.60 | 52.50 | 249.00 |
| F-ESB-160-WT   | 160               | 91.50           | 160.50 | 74.00 | 350.00 |
| F-ESB-200-WT   | 200               | 91.50           | 200.40 | 81.50 | 403.00 |
| F-ESB-250-WT   | 250               | 91.50           | 250.80 | 82.10 | 443.00 |
| F-O-ESB-315-WT | 315               | 91.50           | 315.90 | 90.70 | 546.00 |

## EQUAL SINGLE BRANCH WITH I/O

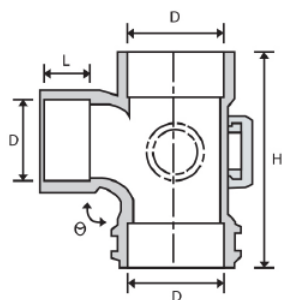

| PRODUCT CODE     | NOMINAL SIZE (MM) | DIMENSIONS (MM) |        |       |        |
|------------------|-------------------|-----------------|--------|-------|--------|
|                  |                   | Angle (θ)       | D      | L     | H      |
| F-ESBIO-043-WT   | 43                | 91.50           | 43.00  | 24.30 | 111.00 |
| F-ESBIO-056-WT   | 56                | 91.50           | 56.00  | 30.00 | 132.60 |
| F-ESBIO-082-WT   | 82                | 91.50           | 82.80  | 43.00 | 208.00 |
| F-ESBIO-110-WT   | 110               | 91.50           | 110.40 | 52.00 | 249.00 |
| F-ESBIO-160-WT   | 160               | 91.50           | 160.50 | 74.00 | 350.00 |
| F-ESBIO-200-WT   | 200               | 91.50           | 200.40 | 81.50 | 403.00 |
| F-ESBIO-250-WT   | 250               | 91.50           | 250.80 | 82.10 | 443.00 |
| F-C-ESBIO-315-WT | 315               | 91.50           | 315.90 | 90.70 | 546.00 |



# PVC-U RAINWATER & SWV FITTINGS

## REDUCING SINGLE BRANCH

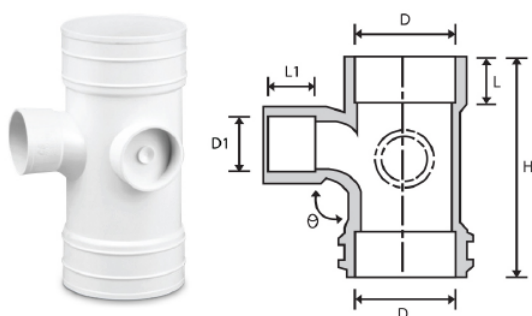

| PRODUCT CODE        | NOMINAL SIZE (MM) | DIMENSIONS (MM) |        |        |       |       |
|---------------------|-------------------|-----------------|--------|--------|-------|-------|
|                     |                   | D               | D1     | H      | L     | L1    |
| F-RSB-082X056-WT    | 82X56             | 83.00           | 56.10  | 175.00 | 45.00 | 30.00 |
| F-RSB-110X056-WT    | 110X56            | 110.60          | 55.90  | 249.00 | 52.00 | 31.00 |
| F-RSB-110X082-WT    | 110X82            | 110.60          | 82.60  | 249.00 | 52.00 | 48.20 |
| F-RSB-160X110-WT    | 160X110           | 160.50          | 110.30 | 315.00 | 74.00 | 50.00 |
| F-RSB-200X110-WT    | 200X110           | 200.80          | 110.50 | 403.00 | 81.50 | 52.40 |
| F-RSB-200X160-WT    | 200X160           | 200.80          | 160.70 | 403.00 | 81.50 | 74.00 |
| F-RSB-250X160-WT    | 250X160           | 250.80          | 160.70 | 443.00 | 82.10 | 74.00 |
| *F-O-RSB-250X110-WT | 250X110           | 250.80          | 110.50 | 310.00 | 80.00 | 48.00 |
| F-RSB-250X200-WT    | 250X200           | 250.80          | 200.80 | 443.00 | 82.10 | 81.50 |
| *F-O-RSB-315X110-WT | 315X110           | 315.90          | 110.50 | 324.00 | 90.00 | 48.00 |
| *F-O-RSB-315X160-WT | 315X160           | 315.90          | 160.70 | 375.00 | 90.00 | 59.00 |
| *F-O-RSB-315X200-WT | 315X200           | 315.90          | 200.40 | 416.00 | 90.00 | 69.00 |
| *F-O-RSB-315X250-WT | 315X250           | 315.90          | 250.80 | 467.00 | 90.00 | 80.00 |

\* Special order items are available on request.

## REDUCING SINGLE BRANCH WITH I/O

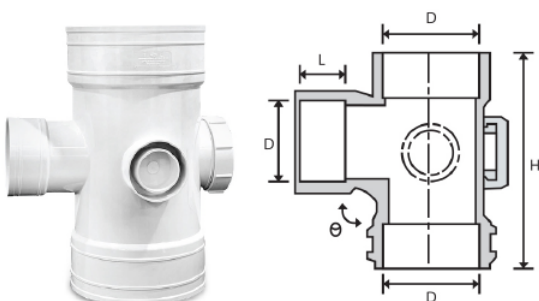

| PRODUCT CODE          | NOMINAL SIZE (MM) | DIMENSIONS (MM) |        |        |       |       |
|-----------------------|-------------------|-----------------|--------|--------|-------|-------|
|                       |                   | D               | D1     | H      | L     | L1    |
| F-RSBIO-082X056-WT    | 82X56             | 83.00           | 56.10  | 175.00 | 45.00 | 30.00 |
| F-RSBIO-160X110-WT    | 160X110           | 160.50          | 110.30 | 315.00 | 74.00 | 50.00 |
| F-RSBIO-200X110-WT    | 200X110           | 200.80          | 110.50 | 403.00 | 81.50 | 52.40 |
| F-RSBIO-200X160-WT    | 200X160           | 200.80          | 160.70 | 403.00 | 81.50 | 74.00 |
| F-RSBIO-250X160-WT    | 250X160           | 250.80          | 160.70 | 443.00 | 82.10 | 74.00 |
| F-RSBIO-250X200-WT    | 250X200           | 250.80          | 200.80 | 443.00 | 82.10 | 81.50 |
| *F-C-RSBIO-315X110-WT | 315X110           | 315.90          | 110.50 | 324.00 | 90.00 | 48.00 |
| *F-C-RSBIO-315X160-WT | 315X160           | 315.90          | 160.70 | 375.00 | 90.00 | 59.00 |
| *F-C-RSBIO-315X200-WT | 315X200           | 315.90          | 200.40 | 416.00 | 90.00 | 69.00 |
| *F-C-RSBIO-315X250-WT | 315X250           | 315.90          | 250.80 | 467.00 | 90.00 | 80.00 |

\* Special order items are available on request.

# PVC-U RAINWATER & SWV FITTINGS

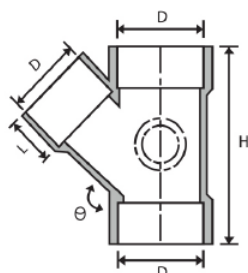

## Y-BRANCH 135°

| PRODUCT CODE       | NOMINAL SIZE (MM) | DIMENSIONS (MM) |        |        |       |
|--------------------|-------------------|-----------------|--------|--------|-------|
|                    |                   | Angle (θ)       | D      | H      | L     |
| F-YB135-082-WT     | 82                | 135.00          | 82.60  | 205.00 | 45.30 |
| F-YB135-110-WT     | 110               | 135.00          | 110.50 | 270.00 | 52.40 |
| F-YB135-160-WT     | 160               | 135.00          | 160.40 | 373.00 | 73.30 |
| F-YB135-200-WT     | 200               | 135.00          | 200.40 | 428.00 | 61.20 |
| * F-O-YB135-250-WT | 250               | 135.00          | 250.80 | 465.00 | 80.00 |
| * F-O-YB135-315-WT | 315               | 135.00          | 315.90 | 562.00 | 90.00 |

\* Special order items are available on request.

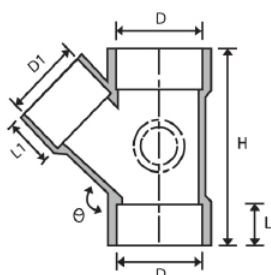

## REDUCING Y-BRANCH 135°

| PRODUCT CODE        | NOMINAL SIZE (MM) | DIMENSIONS (MM) |        |        |       |       |
|---------------------|-------------------|-----------------|--------|--------|-------|-------|
|                     |                   | D               | D1     | H      | L     | L1    |
| F-RYB135-160X110-WT | 160X110           | 160.80          | 110.60 | 306.00 | 74.40 | 52.90 |

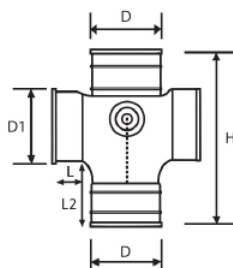

## CROSS TEE 90° [F/F]

| PRODUCT CODE | NOMINAL SIZE (MM) | DIMENSIONS (MM) |        |        |        |       |
|--------------|-------------------|-----------------|--------|--------|--------|-------|
|              |                   | Angle (θ)       | D      | D1     | H      | L     |
| F-CT-110-WT  | 110               | 90.00           | 110.50 | 110.50 | 250.00 | 52.40 |

# PVC-U RAINWATER & SWV FITTINGS

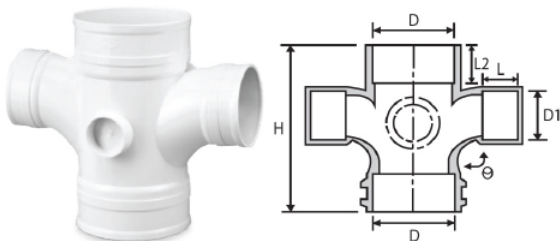

## REDUCING CROSS TEE 90° [F/F]

| PRODUCT CODE     | NOMINAL SIZE (MM) | DIMENSIONS (MM) |        |        |        |       |       |
|------------------|-------------------|-----------------|--------|--------|--------|-------|-------|
|                  |                   | Angle (°)       | D      | D1     | H      | L     | L2    |
| F-RCT-160X110-WT | 160X110           | 87.50           | 160.50 | 110.40 | 315.00 | 50.00 | 74.00 |
| F-RCT-200X110-WT | 200X110           | 87.50           | 200.80 | 110.50 | 403.00 | 52.40 | 81.50 |
| F-RCT-200X160-WT | 200X160           | 87.50           | 200.80 | 160.70 | 403.00 | 74.00 | 81.50 |

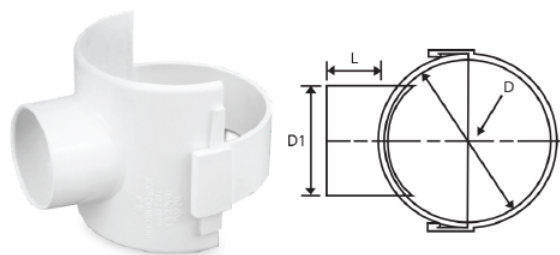

## BOSS CONNECTOR

| PRODUCT CODE    | NOMINAL SIZE (MM) | DIMENSIONS (MM) |        |       |
|-----------------|-------------------|-----------------|--------|-------|
|                 |                   | D               | D1     | L     |
| F-BC-082X056-WT | 82X56             | 82.80           | 56.00  | 30.40 |
| F-BC-110X056-WT | 110X56            | 110.40          | 56.00  | 34.30 |
| F-BC-110X082-WT | 110X82            | 110.40          | 82.70  | 40.80 |
| F-BC-160X082-WT | 160X82            | 160.50          | 82.80  | 44.70 |
| F-BC-160X110-WT | 160X110           | 160.50          | 110.30 | 51.50 |
| F-BC-200X110-WT | 200X110           | 200.70          | 110.50 | 48.00 |
| F-BC-200X160-WT | 200X160           | 200.70          | 160.70 | 58.00 |



## STRAIGHT COUPLING

| PRODUCT CODE | NOMINAL SIZE (MM) | DIMENSIONS (MM) |        |
|--------------|-------------------|-----------------|--------|
|              |                   | D               | L      |
| F-SC-036-WT  | 36                | 36.30           | 26.60  |
| F-SC-043-WT  | 43                | 43.00           | 28.60  |
| F-SC-056-WT  | 56                | 56.10           | 32.00  |
| F-SC-082-WT  | 82                | 82.80           | 46.00  |
| F-SC-110-WT  | 110               | 110.50          | 53.20  |
| F-SC-160-WT  | 160               | 160.50          | 78.20  |
| F-SC-200-WT  | 200               | 200.70          | 81.00  |
| F-SC-250-WT  | 250               | 250.70          | 83.40  |
| F-SC-315-WT  | 315               | 315.90          | 101.20 |



# PVC-U RAINWATER & SWV FITTINGS

## LEVEL INVERT REDUCING SOCKET

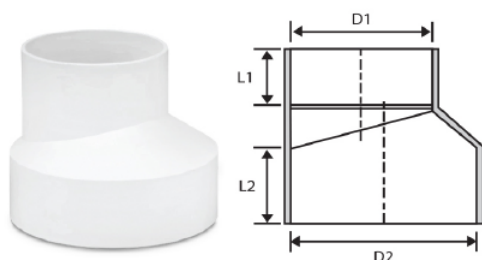

| PRODUCT CODE          | NOMINAL SIZE (MM) | DIMENSIONS (MM) |        |       |       |
|-----------------------|-------------------|-----------------|--------|-------|-------|
|                       |                   | D1              | D2     | L1    | L2    |
| F-LIRS-110X082-WT     | 110X82            | 82.70           | 110.50 | 48.00 | 54.30 |
| F-LIRS-160X110-WT     | 160X110           | 110.30          | 160.50 | 47.80 | 52.20 |
| F-LIRS-200X110-WT     | 200X110           | 110.50          | 200.90 | 62.80 | 68.80 |
| F-LIRS-200X160-WT     | 200X160           | 160.30          | 200.60 | 63.60 | 68.60 |
| F-LIRS-250X110-WT     | 250X110           | 110.60          | 250.70 | 52.00 | 84.00 |
| F-LIRS-250X160-WT     | 250X160           | 160.60          | 250.70 | 61.40 | 84.00 |
| F-LIRS-250X200-WT     | 250X200           | 200.45          | 250.70 | 72.00 | 84.00 |
| * F-O-LIRS-315X200-WT | 315X200           | 315.90          | 200.60 | 90.00 | 72.00 |
| * F-O-LIRS-315X250-WT | 315X250           | 315.90          | 250.80 | 90.00 | 80.00 |

\* Special order items are available on request.

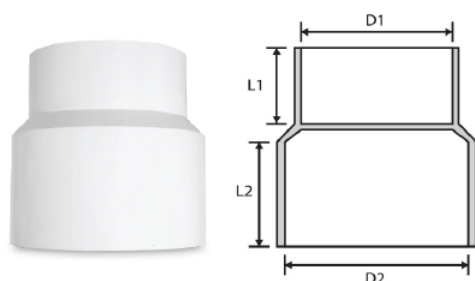

## CONCENTRIC REDUCING SOCKET

| PRODUCT CODE     | NOMINAL SIZE (MM) | DIMENSIONS (MM) |        |       |        |
|------------------|-------------------|-----------------|--------|-------|--------|
|                  |                   | D1              | D2     | L1    | L2     |
| F-CRS-250X200-WT | 250X200           | 200.40          | 250.60 | 83.30 | 143.50 |

## PIPE SLEEVE

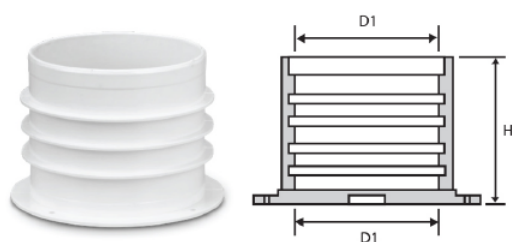

| PRODUCT CODE  | NOMINAL SIZE (MM) | DIMENSIONS (MM) |        |
|---------------|-------------------|-----------------|--------|
|               |                   | D1              | H      |
| F-PS-056-WT   | 56                | 56.10           | 110.00 |
| F-PS-082-WT   | 82                | 82.80           | 95.50  |
| F-PS-110-WT   | 110               | 110.50          | 104.00 |
| F-PS-160-WT   | 160               | 160.70          | 158.30 |
| F-PS-200-WT   | 200               | 200.70          | 171.00 |
| F-C-PS-250-WT | 250               | 250.50          | 80.00  |
| F-C-PS-315-WT | 315               | 316.00          | 100.00 |

# PVC-U RAINWATER & SWV FITTINGS

## BUSH/SOCKET REDUCER

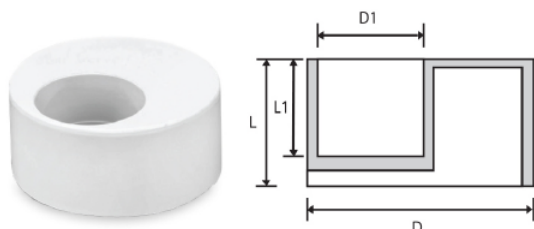

| PRODUCT CODE        | NOMINAL SIZE (MM) | DIMENSIONS (MM) |        |       |       |
|---------------------|-------------------|-----------------|--------|-------|-------|
|                     |                   | D               | D1     | H     | L1    |
| F-RB-043X036-WT     | 43X36             | 42.90           | 36.30  | 22.20 | 18.30 |
| F-RB-056X036-WT     | 56X36             | 55.90           | 36.40  | 28.30 | 18.50 |
| F-RB-056X043-WT     | 56X43             | 55.90           | 42.90  | 28.20 | 22.70 |
| F-RB-082X056-WT     | 82X56             | 82.70           | 56.00  | 38.00 | 28.50 |
| F-RB-110X056-WT     | 110X56            | 110.10          | 56.10  | 49.80 | 28.70 |
| F-RB-110X082-WT     | 110X82            | 110.10          | 82.80  | 49.30 | 37.80 |
| F-RB-160X110-WT     | 160X110           | 160.10          | 110.40 | 77.40 | 49.70 |
| F-RB-200X110-WT     | 200X110           | 200.30          | 110.20 | 57.50 | 54.40 |
| F-RB-200X160-WT     | 200X160           | 200.30          | 160.50 | 57.50 | 54.30 |
| * F-O-RB-250X110-WT | 250X110           | 250.40          | 110.20 | 80.00 | 48.00 |
| * F-O-RB-250X160-WT | 250X160           | 250.40          | 160.40 | 80.00 | 59.00 |
| * F-O-RB-250X200-WT | 250X200           | 250.40          | 200.60 | 80.00 | 69.00 |
| * F-O-RB-315X110-WT | 315X110           | 315.50          | 110.20 | 90.00 | 48.00 |
| * F-O-RB-315X160-WT | 315X160           | 315.50          | 160.40 | 90.00 | 59.00 |
| * F-O-RB-315X200-WT | 315X200           | 315.50          | 200.50 | 90.00 | 69.00 |
| * F-O-RB-315X250-WT | 315X250           | 315.50          | 250.70 | 90.00 | 80.00 |

\* Special order items are available on request.

## FLANGE



| PRODUCT CODE | NOMINAL SIZE (MM) | DIMENSIONS (MM) |        |       |
|--------------|-------------------|-----------------|--------|-------|
|              |                   | D               | L      | BHD   |
| F-FLG-200-WT | 200               | 218.00          | 126.50 | 22.40 |

## U-BODY



| PRODUCT CODE | NOMINAL SIZE (MM) | DIMENSIONS (MM) |       |
|--------------|-------------------|-----------------|-------|
|              |                   | D1              | L1    |
| F-UB-110-WT  | 110               | 110.40          | 46.50 |

# PVC-U RAINWATER & SWV FITTINGS



## SWAN NECK

| PRODUCT CODE | NOMINAL SIZE (MM) | DIMENSIONS (MM) |       |        |
|--------------|-------------------|-----------------|-------|--------|
|              |                   | D               | L     | H      |
| F-SWN-110-WT | 110               | 110.50          | 50.00 | 280.00 |

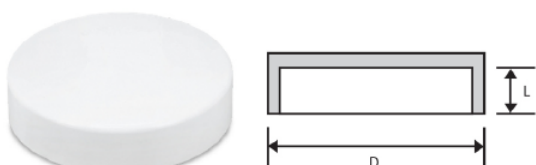

## END CAP

| PRODUCT CODE    | NOMINAL SIZE (MM) | DIMENSIONS (MM) |        |
|-----------------|-------------------|-----------------|--------|
|                 |                   | D               | L      |
| F-EC-056-WT     | 56                | 56.00           | 28.20  |
| F-EC-082-WT     | 82                | 83.00           | 45.00  |
| F-EC-110-WT     | 110               | 110.40          | 23.50  |
| F-EC-160-WT     | 160               | 160.30          | 77.50  |
| F-EC-200-WT     | 200               | 200.60          | 90.00  |
| * F-C-EC-250-WT | 250               | 250.70          | 110.00 |
| * F-C-EC-315-WT | 315               | 315.90          | 125.00 |

\* Special order items are available on request.

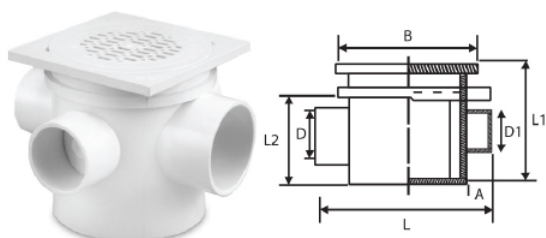

## FLOOR GULLY GRATING SET

| PRODUCT CODE      | SIZE (MM) | DIMENSIONS (MM) |        |        |       |        |       |       |
|-------------------|-----------|-----------------|--------|--------|-------|--------|-------|-------|
|                   |           | L               | L1     | L2     | A     | B      | D     | D1    |
| F-FGGS-110X056-WT | 110X56    | 166.00          | 118.00 | 111.00 | 32.00 | 119.00 | 56.00 | 43.00 |

# PVC-U RAINWATER & SWV FITTINGS

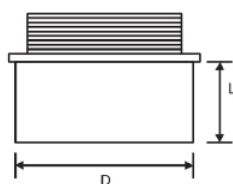
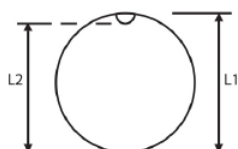

## ACCESS PLUG INSERT ( SCREW REMOVABLE )

| PRODUCT CODE     | NOMINAL SIZE (MM) | DIMENSIONS (MM) |       |        |       |
|------------------|-------------------|-----------------|-------|--------|-------|
|                  |                   | D               | L     | L1     | L2    |
| * F-O-API-043-WT | 43                | 43.00           | 21.00 | 42.90  | -     |
| * F-O-API-056-WT | 56                | 56.00           | 31.00 | 55.90  | -     |
| * F-O-API-082-WT | 82                | 82.00           | 45.00 | 82.60  | -     |
| F-API-110-WT     | 110               | 110.20          | 49.30 | 100.00 | 97.70 |
| * F-O-API-160-WT | 160               | 160.00          | 78.00 | 160.20 | -     |

\* Special order items are available on request.

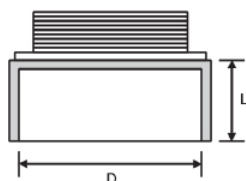
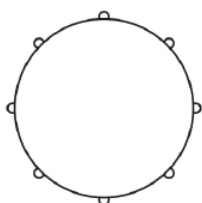

## ACCESS PLUG SOCKET ( SCREW REMOVABLE )

| PRODUCT CODE   | NOMINAL SIZE (MM) | DIMENSIONS (MM) |        |
|----------------|-------------------|-----------------|--------|
|                |                   | D               | L      |
| F-O-APS-200-WT | 200               | 200.60          | 186.00 |
| F-O-APS-250-WT | 250               | 250.70          | 242.00 |
| F-O-APS-315-WT | 315               | 315.90          | 244.00 |



# PVC-U RAINWATER & SWV FITTINGS

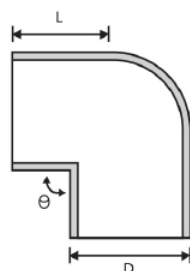

## HEAVY DUTY SWEPT BEND

| PRODUCT CODE       | NOMINAL SIZE (mm) | DIMENSIONS (MM) |        |        |
|--------------------|-------------------|-----------------|--------|--------|
|                    |                   | Angle (θ)       | D      | L      |
| F-RWHD-SB-110-WT   | 110               | 91.50           | 110.50 | 48.00  |
| F-O-RWHD-SB-160-WT | 160               | 91.50           | 160.60 | 73.00  |
| F-O-RWHD-SB-200-WT | 200               | 91.50           | 200.70 | 80.00  |
| F-O-RWHD-SB-250-WT | 250               | 91.50           | 250.80 | 88.00  |
| F-O-RWHD-SB-315-WT | 315               | 91.50           | 315.90 | 110.00 |

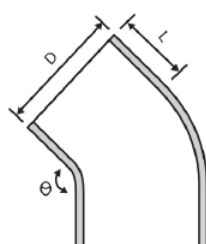

## HEAVY DUTY BEND 135°

| PRODUCT CODE         | NOMINAL SIZE (mm) | DIMENSIONS (MM) |        |        |
|----------------------|-------------------|-----------------|--------|--------|
|                      |                   | Angle (θ)       | D      | L      |
| F-RWHD-B135-110-WT   | 110               | 135.00          | 110.50 | 48.00  |
| F-O-RWHD-B135-160-WT | 160               | 135.00          | 160.60 | 73.00  |
| F-O-RWHD-B135-200-WT | 200               | 135.00          | 200.70 | 80.00  |
| F-O-RWHD-B135-250-WT | 250               | 135.00          | 250.80 | 86.00  |
| F-O-RWHD-B135-315-WT | 315               | 135.00          | 315.90 | 110.00 |

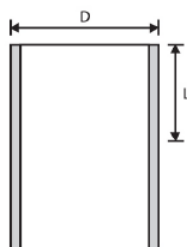

## HEAVY DUTY STRAIGHT COUPLING

| PRODUCT CODE       | NOMINAL SIZE (mm) | DIMENSIONS (MM) |        |
|--------------------|-------------------|-----------------|--------|
|                    |                   | D               | L      |
| F-C-RWHD-SC-110-WT | 110               | 110.50          | 50.00  |
| F-C-RWHD-SC-160-WT | 160               | 160.60          | 80.00  |
| F-C-RWHD-SC-200-WT | 200               | 200.60          | 90.00  |
| F-C-RWHD-SC-250-WT | 250               | 250.80          | 100.00 |
| F-C-RWHD-SC-315-WT | 315               | 316.00          | 120.00 |

# PVC-U RAINWATER & SWV FITTINGS

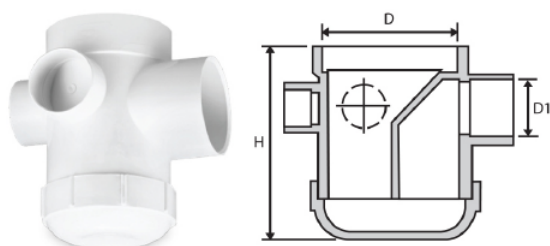

## FLOOR GULLY WITH TRAP I/O

| PRODUCT CODE      | NOMINAL SIZE (mm) | DIMENSIONS (MM) |       |        |
|-------------------|-------------------|-----------------|-------|--------|
|                   |                   | D               | D1    | H      |
| F-FGIO-110X056-WT | 110X56            | 110.40          | 56.00 | 188.00 |
| F-FGIO-110X082-WT | 110X82            | 110.40          | 83.00 | 188.00 |

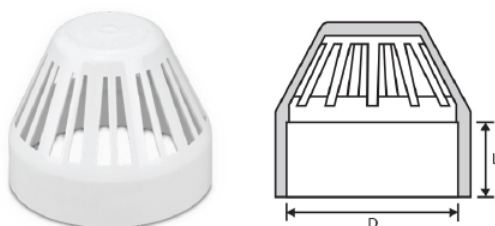

## VENT COWL

| PRODUCT CODE | NOMINAL SIZE (MM) | DIMENSIONS (MM) |       |
|--------------|-------------------|-----------------|-------|
|              |                   | D               | L     |
| F-VC-056-WT  | 56                | 56.00           | 31.00 |
| F-VC-082-WT  | 82                | 82.80           | 25.00 |
| F-VC-110-WT  | 110               | 110.60          | 25.00 |

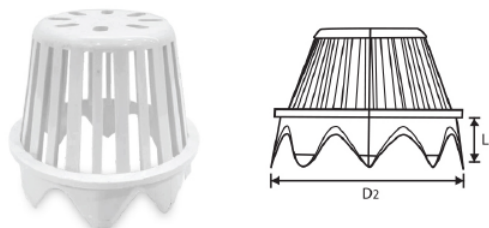

## DOMES FILTER/GRATING

| PRODUCT CODE | NOMINAL SIZE (MM) | DIMENSIONS (MM) |       |
|--------------|-------------------|-----------------|-------|
|              |                   | D               | L     |
| F-DG-110-WT  | 110               | 105.70          | 28.90 |
| F-DG-160-WT  | 160               | 152.00          | 49.70 |
| F-DG-200-WT  | 200               | 192.00          | 62.50 |

# PVC-U RAINWATER DRAINAGE ASSEMBLY SYSTEM



Solvent Cement is a cost effective and highly secure method for pipe assembly. It can be used on PVC-U pipes and socket end pipes. CS's Solvent Cement is recommended for use on PVC and PVC-U pipes. It features superior adhesion, fast setting, and waterproof bonding. Upon full cure, it is safe for drinking water, irrigation, waste water, sanitary pipes, conduits and more.

## Features

- ◆ Reliable and highly secure bonding
- ◆ Cost effective as small amount is needed for each application
- ◆ Strong resistance to vibration and pulsation leaks
- ◆ Watertight adhesion
- ◆ Fast setting and easy installation

# POLYVINYL CHLORIDE (PVC) SOLVENT CEMENT

**CS** solvent cement is a formulated premium quality liquid adhesive which is used to create an airtight seal that holds PVC-U pipe and fittings together. Our solvent cement features strong bonding strength, fast-dry, slow-dry and waterproof seal. It is safe for drinking-water supply piping, sanitary pipes, water irrigation and etc. All of our solvent cement has been certified by Sirim QAS International in compliance with MS 628-4:2015. (equivalent to British Standard BS 4346 Part 3)



**Product Code: SSCPVC500-T**

Colour : Transparent (Fast Dry)  
Solid consists of : MEK & CYC



**Product Code: SSCPVC500-G**

Colour : Green (Fast Dry)  
Solid consists of : MEK & CYC



**Product Code: SSCPVC500-B**

Colour : Blue (Slow Dry)  
Solid consists of : MEK, CYC & THF

Solid content : 24%

Consistency property : 1,000pcs

Quality : Tough & Resistance

Comply to Standard : MS 628-4: 2015

- ♦ A highly soluble **FAST DRY** and **SLOW DRY** PVC-U Solvent cement is available.
- ♦ When applied, it will instantly dissolve and blend with the pipe to produce a film (wall) of 0.4mm thick, so that the fitting gap will be strong and stable.

## RECOMMENDATIONS ON BRUSH :-

A : Pipes with diameter 25mm (1") and below - recommended brush are provided with the can.

B : Pipes with diameter 32mm to 50mm (1 1/4" to 2") - use 1" brush

C : Pipes with diameter 75mm to 200mm (3" to 8" and above) - use 2" brush

## PRESSURE TEST

Cold Water (20°C)

Hot Water (60°C)

## TEST PRESSURE

Below 12kg/cm<sup>2</sup>(171psi)

Below 12kg/cm<sup>2</sup>(171psi)

## DRYING TIME

After 1 hour

After 2 hour

## MATERIAL SAFETY DATA SHEET

### COMPOSITION/INFORMATION ON INGREDIENT:

| Ingredient | PVC Resin | Cyclohexanone | Methyl Isobuty Ketone (MIBK) | T.H.F.   | Methyl Ethynyl Keltone (MEK) |
|------------|-----------|---------------|------------------------------|----------|------------------------------|
| CAS No.    | 9003-22-9 | 108-94-1      | 141-79-7                     | 109-99-9 | 78-93-3                      |
| % - volume | 24%       | 30%           | 11%                          | 4%       | 55%                          |

## ESTIMATED SOLVENT CEMENT REQUIREMENT:-

| NORMINAL/SIZES |      | Number of Possible Joints 500g |
|----------------|------|--------------------------------|
| (IN.)          | (MM) |                                |
| 1/2            | 32   | 383                            |
| 3/4            | 40   | 250                            |
| 1              | 50   | 200                            |
| 1 1/4          | 80   | 156                            |

| NORMINAL/SIZES |      | Number of Possible Joints 500g |
|----------------|------|--------------------------------|
| (IN.)          | (MM) |                                |
| 1 1/2          | 40   | 100                            |
| 2              | 50   | 69                             |
| 3              | 80   | 41                             |
| 4              | 100  | 32                             |

| NORMINAL/SIZES |      | Number of Possible Joints 500g |
|----------------|------|--------------------------------|
| (IN.)          | (MM) |                                |
| 6              | 155  | 19                             |
| 8              | 200  | 10                             |
| 10             | 250  | 6                              |
| 12             | 300  | 4                              |

## PHYSICAL AND CHEMICAL PROPERTIES

Appearance : Clear Flash Point : 15°C DG Class : 3.2

## Flammable Mixture (UN No. 1133)

This solvent cement material will ignite at ambient temperatures. Colourless vapors may travel considerable distance to ignition sources and cause flash fires or explosions.

## HAZARD IDENTIFICATION

May cause eyes and skin irritation, burns or dermatitis.

## STORAGE

Store in well-ventilated area. Keep away from heat, sparks and flame.

## SAFETY PHASE

- Keep away from sources of ignition - No-Smoking.
- Avoid contact with eyes.
- In case of fire, use chemical powder, foam or carbon dioxide.



# INSTALLATION GUIDE



## Preparation

Prepare all the needed tools and equipment for the pipe installation.



## Marking

Mark the socket depth on the pipe end.



## Cutting the Pipe

Cut the pipe with the proper tool, using a fine-toothed saw.



## Joint Preparation

Slightly deburr the external pipe edge and break off any sharp edges.



## Cleaning

Thoroughly clean all surfaces to be joined. Any dirt, moisture, oil and other foreign material will affect the joining's integrity.



## Test Dry Fit of the joint

Insert the spigot into the socket without the solvent cement to check the fit. An interference fit should occur between 1/3 and 2/3 of full entry.



## Witness Mark the pipe

Draw a line on the spigot to show the depth of the socket.



## Apply Solvent Cement on Pipe

Apply an even coat of solvent to the pipe marked for joining.



## Apply Solvent Cement on Fitting

Apply an even coat of solvent to the inside of the spigot or socket.



## Assembly of joint

While both parts to be joined are still wet, put the spigot into the socket in a slightly twisting motion. Hold the cemented joint idle for a minimum of 30 seconds for secure adhesion.



## Clean off

Wipe off excess cement from the pipe at the end of the socket. Any gaps in the cement ring around the pipe perimeter may indicate a defective assembly.

## NOTEPAD



## OTHER CS CATALOGUES



**PVC-U Pressure Pipe System**



**PP-R Hot & Cold Water System**

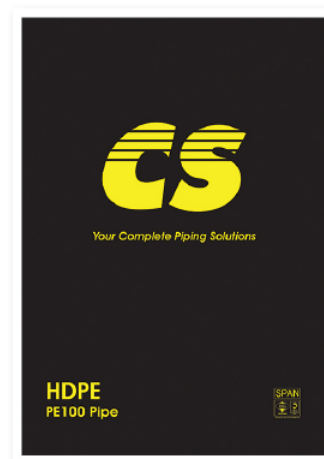

**HDPE PE100 Pipe**

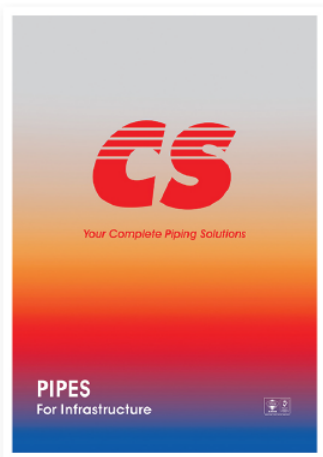

**Pipes For Infrastructure**



**PVC-U Soil, Waste, Vent System**

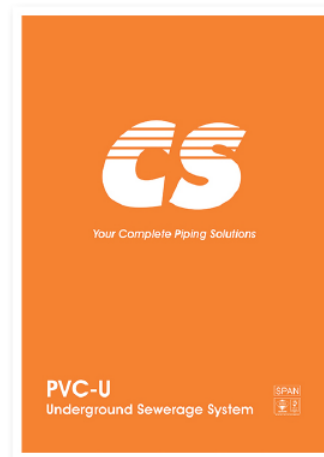

**PVC-U Underground Sewerage System**



*Your Complete Piping Solutions*



Water Storage Tank, Waste Water Management  
& Road Safety Management

## CONTACT US

Tel: +605-201 1273  
Fax: +605-201 1062  
Email: [cs@cewsin.com.my](mailto:cs@cewsin.com.my)  
Website: [www.cewsin.com.my](http://www.cewsin.com.my)



CS-RWD/202211/01B

Scan the QR code  
to get **more & quick information**  
from our new catalogue!

**Disclaimer:**

The information provided by Cew Sin Plastic Pipe Sdn. Bhd. in this catalogue is for general informational purposes only. All information in this catalogue is provided in good faith. However, we make no representation or warranty of any kind, express or implied, regarding the accuracy, adequacy, validity, reliability or completeness of any information in this catalogue. Under no circumstance shall we have any liability to you for any loss or damage of any kind incurred as a result of the use of this information. Your use of the catalogue and your reliance on any information provided is solely at your own risk.