



Your Complete Piping Solutions

PVC-U

Soil, Waste, Vent System





Cew Sin Plastic Pipe Sdn. Bhd. (243310-M) was founded in 1992 and is a renowned plastic pipe manufacturer in Malaysia that specializes in Unplasticized Polyvinyl Chloride (PVC-U) Pipes and Fittings, Polypropylene Random (PP-R) Pipes and Fittings and High-Density Polyethylene (HDPE) Pipes. Cew Sin (CS) uses primarily PVC-U, PP-R and HDPE raw materials to manufacture high-quality, safe and reliable plastic pipes and fittings for a wide range of applications, including water supply, drainage, sewage, cable and wire conduits for a wide spectrum of industries such as construction, infrastructure, utility, agriculture and many more. It is our cutting-edge technology and proven track record of quality excellence that has made us a respected leader in the market.

CS is also committed to providing green solutions for our customers. We offer environmentally friendly, lead-free options for our pipes and fittings. Our products also comply with various national and international professional certifications as part of our pursuit of quality excellence. At the same time, we invest heavily in Research and Development because we believe in continuously upgrading the quality of our products, as befitting our status as a market leader in Malaysia.

We owe our achievements in the plastic pipe manufacturing industry to sound management, professional production, continuous upgrades and efficient services. Our endeavours over the years have made us a well-trusted brand in both the domestic and international market.

We are ISO 9001:2015 Quality Management System certified, while stringent measures are adopted to ensure a high product quality that meets our local and export customers' needs. Our products are also endorsed by SIRIM QAS (Standard of Industrial and Research Institute in Malaysia) and SLS (Singapore Laboratory Services) certified according to local and international standards.

Apart from international certification, our pipes and fittings meet the requirements of the Malaysian National Water Authority (Suruhanjaya Perkhidmatan Air Negara or SPAN), Jabatan Air Negeri Sabah, and the State Water Authority of Sarawak.

COMPANY BACKGROUND

2

Company Background

4

Vision, Mission and Quality Policy

6

Introduction and Product Code

8

**PVC-U Soil, Waste and Vent (SWV) Pipes
Product Feature and Information**

10

**PVC-U SWV & Rainwater Fittings
Product Size and Dimension**

24

**PVC-U Soil, Waste, Vent
Assembly System**

26

Installation Guide

27

Other Catalogues

**THE
NEW
TREN
CON**



OUR COMMITMENTS AND SERVICES



VISION

To become the leading manufacturer and distributor of complete PVC-U, PP-R and HDPE piping systems in the region.

MISSION

To ensure total customer satisfaction through continuously improving our products, resources, facilities and services.

QUALITY POLICIES

- ◆ Customer satisfaction is our top priority
- ◆ Strive to be the best in the industry
- ◆ People competency is the key driver
- ◆ Plan for and commit to continuous improvement

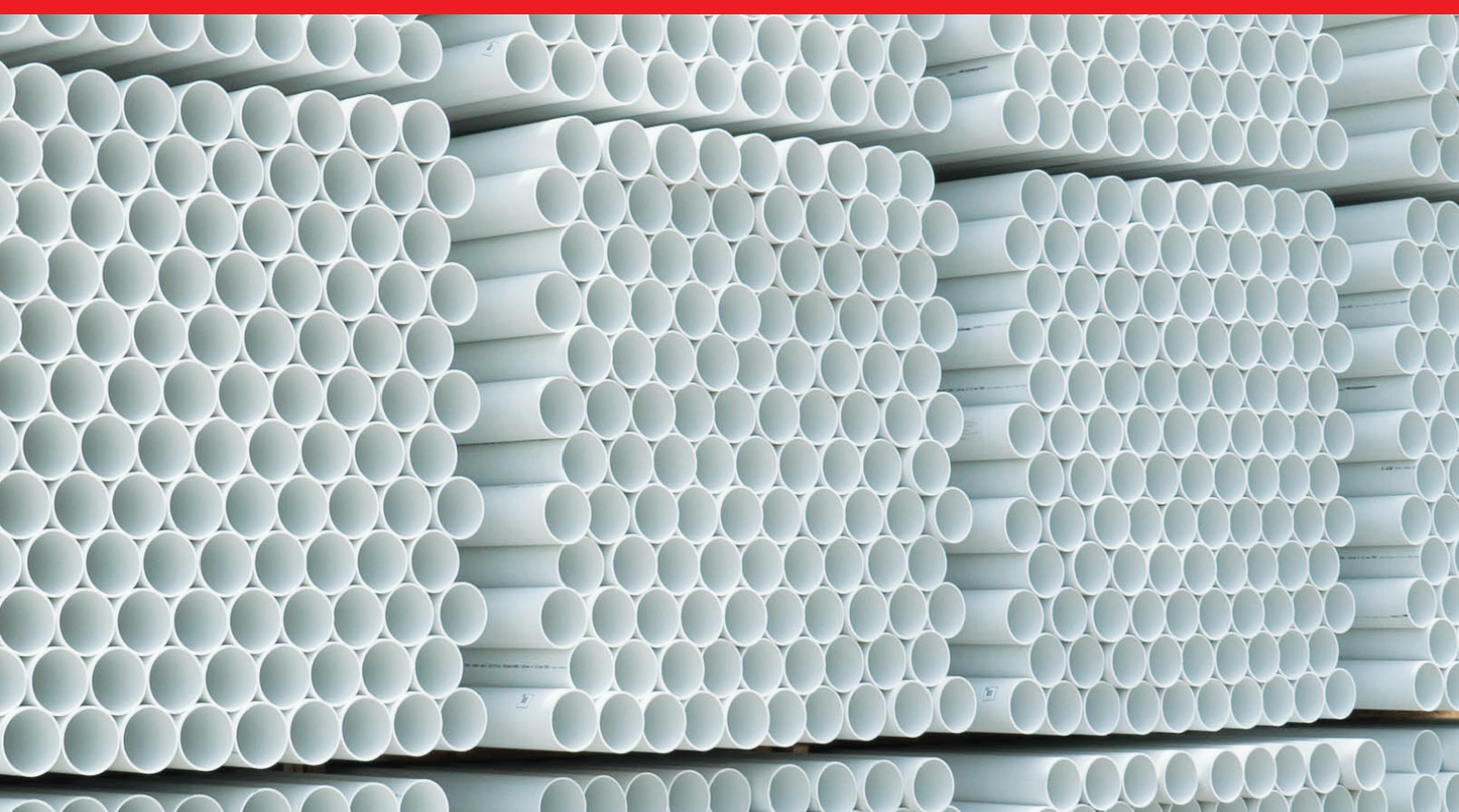

STATE-OF-THE-ART LABORATORY

CS strongly believes in the importance of high-quality, durable, safe, and reliable products. We have a comprehensive range of equipment in our laboratory where all products are rigorously tested in compliance with local and international standards. Fine raw materials and compounds are assessed in terms of temperature, pressure, and energy input, while pipe samples are put under stringent impact and tensile strength inspections. Our dedicated Research and Development team is also always working on developing new ways to upgrade the quality of our pipes and fittings as according to industry standards.

OUR ACCREDITED CERTIFICATION BODIES

CS's wide range of products adheres to ISO 9001 certification, as well as both local and international standards, including but not limited to:



PVC-U PIPES: SOIL, WASTE, VENT & RAINWATER PIPES AND FITTINGS

This range of PVC-U pipes is engineered for exceptional weathering resistance and superior corrosion protection. Rigorously tested to comply with local and international standards, these pipes are suitable for soil, waste, and ventilation systems—both inside buildings and embedded within concrete structures. Manufactured from high-quality PVC-U resin and premium compounds, they deliver reliable, long-lasting performance with uncompromising safety and durability.

Features:

- ◆ Recommended for internal plumbing and construction projects
- ◆ Superior resistance to chemical corrosion ensures long lifespan
- ◆ Low maintenance due to high abrasion resistance
- ◆ Strong endurance to weathering effects
- ◆ Rigorously tested according to local and international standards
- ◆ Durable, reliable, and safe
- ◆ Only available in white colour

CS Pipe Marking

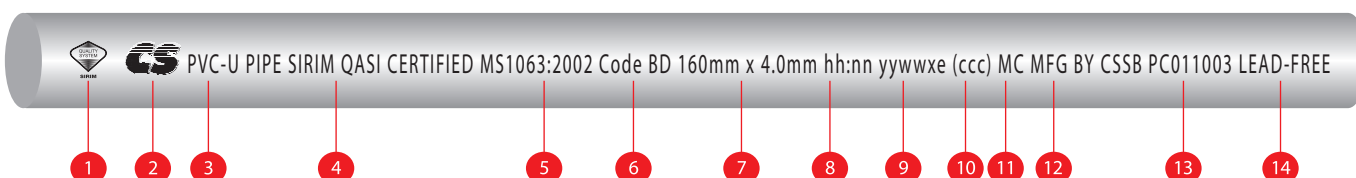

① SIRIM Logo 

② CEW SIN Logo 

③ Material

④ Certification Body

⑤ Standard References and Conformance

⑥ Application and Area Code

⑦ Nominal Size & Wall Thickness

⑧ Time and Minutes

⑨ Production code (yy-year/ww-weeks/x-day of weeks/e-shift)

⑩ Counter Batch

⑪ Machine no.

⑫ Manufacture Code

⑬ SIRIM License Number

⑭ LEAD-FREE Formulation



PRODUCT CODE

PVC-U PIPE NEW CODE

PS-W-160-BD-5.8-WT

GROUP+
SERIES

PRODUCT

DIAMETER
SIZES

CLASS

LENGTH

COLOUR

PVC-U FITTINGS NEW CODE

F-SB-160-WT

GROUP+
SERIES

PRODUCT

DIAMETER
SIZES

COLOUR

GROUP

P	PIPE
F	FITTINGS
O	OTHERS

SERIES

S	SIRIM
C	CUSTOM MADE

PRODUCT & CLASS

W	SOIL, WASTE & VENT (S.W.V.)
B	CODE : B
BD	CODE : BD

FITTINGS

SB	SWEPT BEND
SBIO	SWEPT BEND WITH I/O
B135	BEND PLAIN 135°
B135IO	BEND PLAIN 135° WITH I/O
B68	BEND PLAIN 112° / 68°
B68IO	BEND PLAIN 112° / 68° WITH I/O
BB	BOSSSED BEND [M/F]
BBIO	BOSSSED BEND WITH I/O [M/F]
RB90	REDUCING BEND 90°
ESB	EQUAL SINGLE BRANCH
ESBIO	EQUAL SINGLE BRANCH WITH I/O
RSB	REDUCING SINGLE BRANCH
RSBIO	REDUCING SINGLE BRANCH WITH I/O
YB135	Y-BRANCH 135°
RYB135	REDUCING Y-BRANCH 135°
CT	CROSS TEE 90° [F/F]
RCT	REDUCING CROSS TEE 90° [F/F]
BC	BOSS CONNECTOR
SC	STRAIGHT COUPLING
LIRS	LEVEL INVERT REDUCING SOCKET
CRS	CONCENTRIC REDUCING SOCKET
PS	PIPE SLEEVE
RB	BUSH / SOCKET REDUCER
EC	END CAP
API	ACCESS PLUG INSERT
APS	ACCESS PLUG SOCKET
FGGS	FLOOR GULLY GRATING SET
FGIO	FLOOR GULLY WITH TRAP / I/O
VC	VENT COWL
UB	U-BODY
SWN	SWAN NECK

PTR	P-TRAP
PTR-UB	P-TRAP (U-BODY)
PTRIO	P-TRAP WITH I/O
STR-UB	S-TRAP (U-BODY)
STRIO	S-TRAP WITH I/O
STRIO-UB	S-TRAP WITH I/O (U-BODY)
FS	FAUCET SOCKET
FB90	FAUCET BEND 90°

DIAMETER / SIZES

36MM	1 1/4"
43MM	1 1/2"
56MM	2"
82MM	3"
110MM	4"
160MM	6"
200MM	8"
250MM	10"
315MM	12"

LENGTH

4.0	4.0 MTR
5.8	5.8 MTR
6.0	6.0 MTR

COLOR

WT	WHITE
----	-------

PVC-U SOIL, WASTE AND VENT (SWV) PIPES

MS 1063:2002

(BS EN 1329)



CS's PVC-U SWV pipes are designed to withstand weathering effects even in harsh climates and remain stable under elevated temperatures. These pipes are highly versatile and can be installed inside buildings, above ground, or buried within building structures, depending on the range. CS offers two types of PVC-U SWV pipes: Code B and Code BD.

Features:

- ◆ Suitable for use inside buildings, above ground, or buried within building structures
- ◆ Recommended for drainage applications and construction projects
- ◆ Superior resistance to chemical corrosion ensures a long lifespan
- ◆ Low maintenance due to high abrasion resistance
- ◆ Strong endurance against weathering effects
- ◆ Rigorously tested according to local and international standards
- ◆ Only available in white color



PVC-U PIPES

PVC-U SOIL, WASTE & VENT PIPES (SWV)

MS 1063:2002

(BSEN 1329)

CODE B

PRODUCT CODE	NOMINAL/SIZES		OUTSIDE DIAMETER (MM)		WALL THICKNESS (MM)		LENGTH (METER)
	(IN.)	(MM)	MIN	MAX	MIN	MAX	
PS-W-036-5.8-WT	1-1/4	36	36.20	36.50	3.00	3.50	5.8
PS-W-043-5.8-WT	1-1/2	43	42.80	43.10	3.00	3.50	5.8
PS-W-056-5.8-WT	2	56	55.80	56.10	3.00	3.50	5.8
PS-W-082-5.8-WT	3	82	82.40	82.80	3.00	3.50	5.8
PS-W-110-5.8-WT	4	110	110.00	110.30	3.20	3.80	5.8
PS-W-160-5.8-WT	6	160	160.00	160.40	3.20	3.80	5.8
PS-W-200-5.8-WT	8	200	200.00	200.50	3.90	4.50	5.8
PS-W-250-5.8-WT	10	250	250.00	250.50	4.90	5.60	5.8
PS-W-315-5.8-WT	12	315	315.00	315.60	6.20	7.10	5.8

Code "B"= Application area code for components intended for use above ground inside buildings, or for components outside buildings fixed onto the wall.

CODE BD

PRODUCT CODE	NOMINAL/SIZES		OUTSIDE DIAMETER (MM)		WALL THICKNESS (MM)		LENGTH (METER)
	(IN.)	(MM)	MIN	MAX	MIN	MAX	
PS-W-082-BD-5.8-WT	3	82	82.40	82.80	3.00	3.50	5.8
PS-W-110-BD-5.8-WT	4	110	110.00	110.30	3.20	3.80	5.8
PS-W-160-BD-5.8-WT	6	160	160.00	160.40	4.00	4.60	5.8
PS-W-200-BD-5.8-WT	8	200	200.00	200.50	4.90	5.60	5.8
PS-W-250-BD-5.8-WT	10	250	250.00	250.50	6.20	7.10	5.8
PS-W-315-BD-5.8-WT	12	315	315.00	315.60	7.70	8.70	5.8

Code "BD"= Application area code for components intended for above ground use for both inside buildings, or for components outside buildings fixed onto the wall and buried in building structures.

PVC-U SWV & RAINWATER FITTINGS

SWEPT BEND

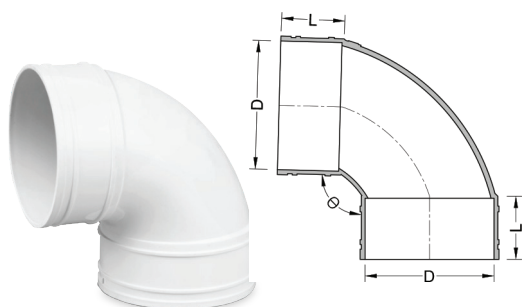

PRODUCT CODE	NOMINAL SIZE (mm)	DIMENSIONS (MM)		
		Angle (θ)	D	L
F-SB-036-WT	36	91.50	36.30	18.00
F-SB-043-WT	43	91.50	42.90	21.00
F-SB-056-WT	56	91.50	56.00	32.20
F-SB-082-WT	82	91.50	82.80	45.00
F-SB-110-WT	110	91.50	110.50	52.30
F-SB-160-WT	160	91.50	160.60	78.50
F-SB-200-WT	200	87.50	200.70	81.60
F-SB-250-WT	250	87.50	250.50	82.10
F-SB-315-WT	315	87.50	315.65	90.00

SWEPT BEND WITH I/O

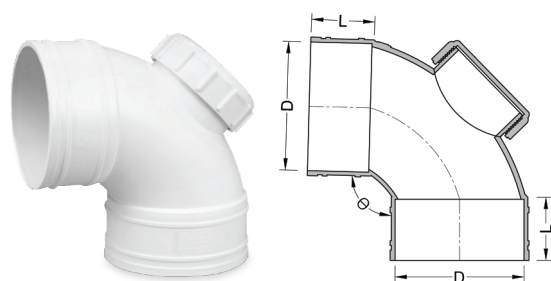

PRODUCT CODE	NOMINAL SIZE (mm)	DIMENSIONS (MM)		
		Angle (θ)	D	L
F-SBIO-043-WT	43	91.50	43.00	21.00
F-SBIO-056-WT	56	91.50	56.10	32.00
F-SBIO-082-WT	82	91.50	82.80	45.00
F-SBIO-110-WT	110	91.50	110.50	52.30
F-SBIO-160-WT	160	91.50	160.60	78.50
F-SBIO-200-WT	200	91.50	200.70	81.60
F-SBIO-250-WT	250	87.50	250.50	82.10
F-SBIO-315-WT	315	87.50	315.65	90.00

BEND PLAIN 135°

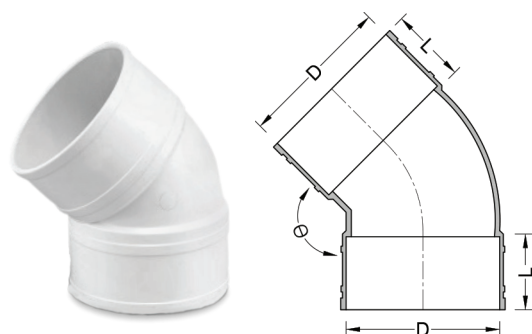

PRODUCT CODE	NOMINAL SIZE (mm)	DIMENSIONS (MM)		
		Angle (θ)	D	L
F-B135-036-WT	36	135.00	36.40	24.00
F-B135-043-WT	43	135.00	43.10	27.00
F-B135-056-WT	56	135.00	56.00	30.00
F-B135-082-WT	82	135.00	82.80	45.50
F-B135-110-WT	110	135.00	110.40	48.00
F-B135-160-WT	160	135.00	160.80	77.40
F-B135-200-WT	200	135.00	200.40	81.10
F-B135-250-WT	250	135.00	250.60	85.60
F-B135-315-WT	315	135.00	315.65	90.00

PVC-U SWV & RAINWATER FITTINGS

BEND PLAIN 135° I/O

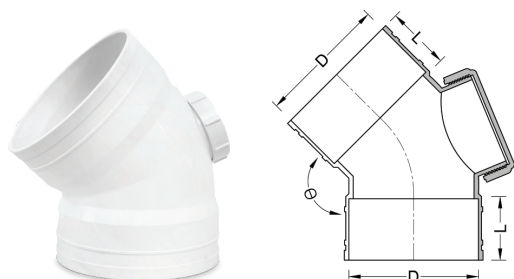

PRODUCT CODE	NOMINAL SIZE (mm)	DIMENSIONS (MM)		
		Angle (θ)	D	L
F-B135IO-110-WT	110	135.00	110.40	48.00
F-B135IO-160-WT	160	135.00	160.50	78.00
F-B135IO-200-WT	200	135.00	200.70	80.00
F-B135IO-250-WT	250	135.00	250.60	85.60
F-B135IO-315-WT	315	135.00	315.65	90.00

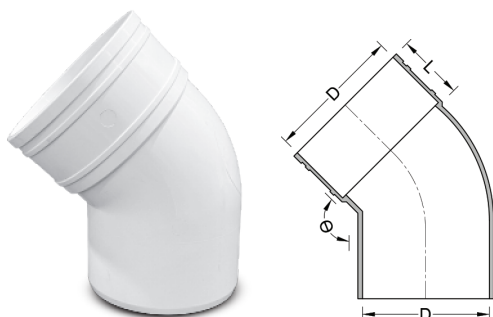

BOSSED BEND 135°

PRODUCT CODE	NOMINAL SIZE (mm)	DIMENSIONS (MM)			
		Angle (θ)	D	L	H
F-BB135-110-WT	110	135.00	110.40	52.20	19.00

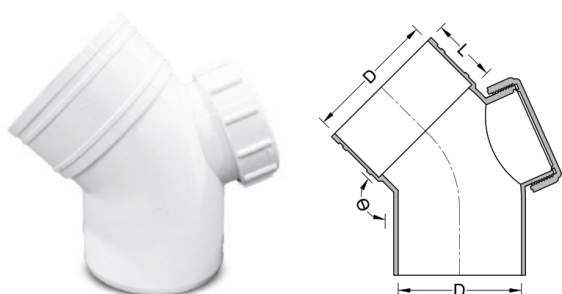

BOSSED BEND 135° I/O

PRODUCT CODE	NOMINAL SIZE (mm)	DIMENSIONS (MM)			
		Angle (θ)	D	L	H
F-BB135IO-110-WT	110	135.00	110.40	52.20	19.00

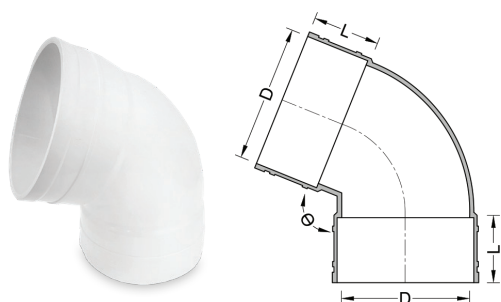

BEND PLAIN 112° / 68°

PRODUCT CODE	NOMINAL SIZE (mm)	DIMENSIONS (MM)		
		Angle (θ)	D	L
F-C-B68-110-WT	110	68	110.40	52.50
F-C-B68-160-WT	160	68	160.50	78.00
F-B68-200-WT	200	68	200.60	80.20
F-C-B68-250-WT	250	68	250.70	86.00
F-C-B68-315-WT	315	68	315.20	101.70

PVC-U SWV & RAINWATER FITTINGS

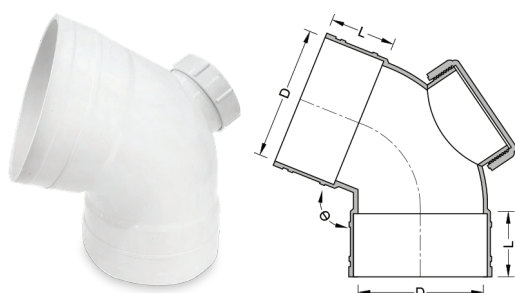

BEND PLAIN 112° / 68° WITH I/O

PRODUCT CODE	NOMINAL SIZE (mm)	DIMENSIONS (MM)		
		Angle (°)	D	L
F-C-B68IO-110-WT	110	68.00	110.40	52.50
F-C-B68IO-160-WT	160	68.00	160.50	78.00
F-B68IO-200-WT	200	68.00	200.81	80.00
F-C-B68IO-250-WT	250	68.00	250.70	86.00
F-C-B68IO-315-WT	315	68.00	315.20	101.70

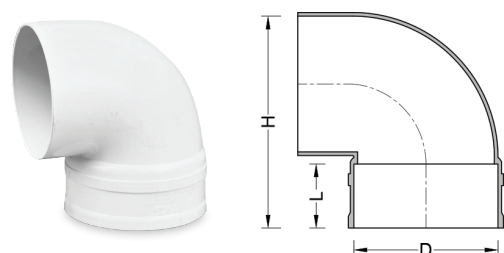

BOSSED BEND [M/F]

PRODUCT CODE	NOMINAL SIZE (mm)	DIMENSIONS (MM)			
		Angle (°)	D	L	H
F-BB-110-WT	110	90.00	110.40	49.50	162.00

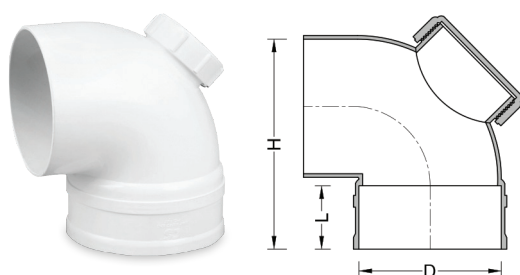

BOSSED BEND WITH I/O [M/F]

PRODUCT CODE	NOMINAL SIZE (mm)	DIMENSIONS (MM)			
		Angle (°)	D	L	H
F-BBIO-110-WT	110	90.00	110.40	49.50	162.00

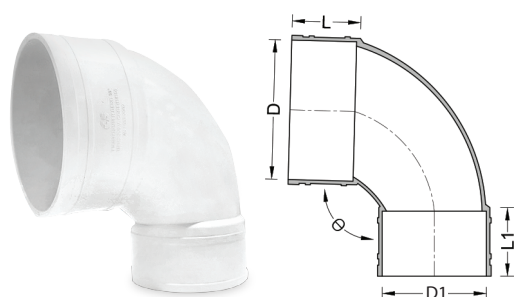

REDUCING BEND 90°

PRODUCT CODE	NOMINAL SIZE (mm)	DIMENSIONS (MM)				
		Angle (°)	D1	D2	L1	L2
F-RB90-110X082-WT	100X82	90.00	110.50	83.00	52.40	45.00

PVC-U SWV & RAINWATER FITTINGS

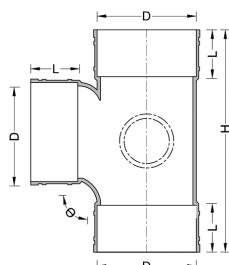

EQUAL SINGLE BRANCH (swept)

PRODUCT CODE	NOMINAL SIZE (mm)	DIMENSIONS (MM)			
		Angle (θ)	D	L	H
F-ESB-036-WT	36	91.50	36.30	24.00	94.80
F-ESB-043-WT	43	91.50	43.00	24.10	110.60
F-ESB-056-WT	56	91.50	56.00	30.00	133.00
F-ESB-082-WT	82	91.50	82.80	45.00	206.60
F-ESB-110-WT	110	91.50	110.60	52.50	249.00

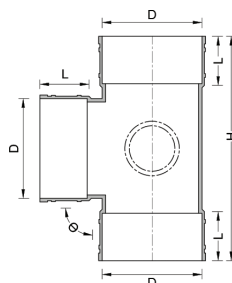

EQUAL SINGLE BRANCH (unswept)

PRODUCT CODE	NOMINAL SIZE (mm)	DIMENSIONS (MM)			
		Angle (θ)	D	L	H
F-ESB-160-WT	160	87.50	160.50	74.00	350.00
F-ESB-200-WT	200	91.50	200.40	81.50	403.00
F-ESB-250-WT	250	87.50	250.80	82.10	443.00
F-ESB-315-WT	315	87.50	315.65	90.00	545.00

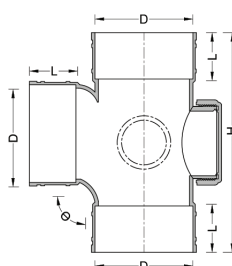

EQUAL SINGLE BRANCH WITH I/O (swept)

PRODUCT CODE	NOMINAL SIZE (mm)	DIMENSIONS (MM)			
		Angle (θ)	D	L	H
F-ESBIO-043-WT	43	91.50	43.00	24.30	111.00
F-ESBIO-056-WT	56	91.50	56.00	30.00	132.60
F-ESBIO-082-WT	82	91.50	82.80	43.00	208.00
F-ESBIO-110-WT	110	91.50	110.40	52.00	249.00

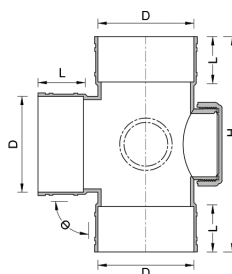

EQUAL SINGLE BRANCH WITH I/O (unswept)

PRODUCT CODE	NOMINAL SIZE (mm)	DIMENSIONS (MM)			
		Angle (θ)	D	L	H
F-ESBIO-160-WT	160	87.50	160.50	74.00	350.00
F-ESBIO-200-WT	200	91.50	200.40	81.50	403.00
F-ESBIO-250-WT	250	87.50	250.80	82.10	443.00
F-ESBIO-315-WT	315	87.50	315.65	90.00	545.00

PVC-U SWV & RAINWATER FITTINGS

REDUCING SINGLE BRANCH (swept)

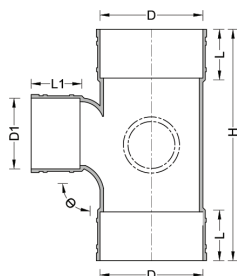

PRODUCT CODE	NOMINAL SIZE (mm)	DIMENSIONS (MM)					
		Angle (θ)	D	D1	L	L2	H
F-RSB-082X056-WT	82X56	91.50	83.00	56.10	45.00	30.00	175.00
F-RSB-110X056-WT	110X56	91.50	110.60	55.90	45.00	31.00	249.00
F-RSB-110X082-WT	110X82	91.50	110.60	82.60	52.00	48.20	249.00

REDUCING SINGLE BRANCH (unswept)

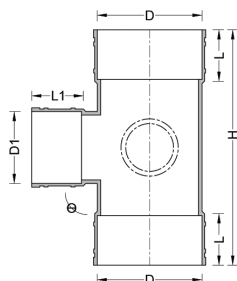

PRODUCT CODE	NOMINAL SIZE (mm)	DIMENSIONS (MM)					
		Angle (θ)	D	D1	L	L2	H
F-RSB-160X110-WT	160X110	87.50	160.50	110.30	74.00	50.00	315.00
F-RSB-200X110-WT	200X110	91.50	200.80	110.50	81.50	52.40	403.00
F-RSB-200X160-WT	200X160	91.50	200.80	160.70	81.50	74.00	403.00
*F-O-RSB-250X110-WT	250X110	87.50	250.80	110.50	80.00	48.00	310.00
F-RSB-250X160-WT	250X160	87.50	250.80	160.70	82.10	74.00	443.00
F-RSB-250X200-WT	250X200	87.50	250.80	200.80	82.10	81.50	443.00
F-RSB-315X110-WT	315X110	87.50	315.65	110.40	90.00	52.40	434.00
F-RSB-315X160-WT	315X160	87.50	315.65	160.60	90.00	74.00	434.00
F-RSB-315X200-WT	315X200	87.50	315.65	200.70	90.00	81.50	520.00
F-RSB-315X250-WT	315X250	87.50	315.65	250.70	90.00	82.10	520.00

*Special order items are available on request.

REDUCING SINGLE BRANCH WITH I/O (swept)

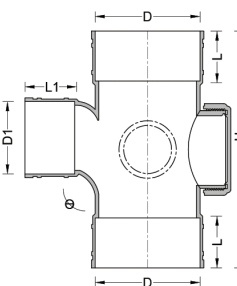

PRODUCT CODE	NOMINAL SIZE (mm)	DIMENSIONS (MM)					
		Angle (θ)	D	D1	L	L2	H
F-RSBIO-082X056-WT	82X56	91.50	83.00	56.10	45.00	30.00	175.00

REDUCING SINGLE BRANCH WITH I/O (unswept)

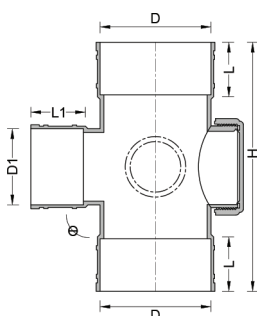

PRODUCT CODE	NOMINAL SIZE (mm)	DIMENSIONS (MM)					
		Angle (θ)	D	D1	L	L2	H
F-RSBIO-160X110-WT	160X110	87.50	160.50	110.30	74.00	50.00	315.00
F-RSBIO-200X110-WT	200X110	91.00	200.80	110.50	81.50	52.40	403.00
F-RSBIO-200X160-WT	200X160	91.00	200.80	160.70	81.50	74.00	403.00
F-RSBIO-250X160-WT	250X160	87.50	250.80	160.70	82.10	74.00	443.00
F-RSBIO-250X200-WT	250X200	87.50	250.80	200.80	82.10	81.50	443.00
F-RSBIO-315X110-WT	315X110	87.50	315.65	110.40	90.00	52.40	434.00
F-RSBIO-315X160-WT	315X160	87.50	315.65	160.60	90.00	74.00	434.00
F-RSBIO-315X200-WT	315X200	87.50	315.65	200.70	90.00	81.50	520.00
F-RSBIO-315X250-WT	315X250	87.50	315.65	250.70	90.00	82.10	520.00

PVC-U SWV & RAINWATER FITTINGS

Y-BRANCH 135° WITH I/O

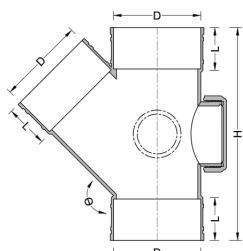

PRODUCT CODE	NOMINAL SIZE (mm)	DIMENSIONS (MM)			
		Angle (θ)	D	L	H
*F-C-YB135IO-082-WT	82	135.00	82.60	45.30	205.00
F-C-YB135IO-110-WT	110	135.00	110.50	52.40	270.00
*F-C-YB135IO-160-WT	160	135.00	160.40	73.30	373.00
*F-C-YB135IO-200-WT	200	135.00	200.40	61.20	428.00
*F-C-YB135IO-250-WT	250	135.00	250.80	80.00	465.00
*F-C-YB135IO-315-WT	315	135.00	315.90	90.00	562.00

*Special order items are available on request.

Y-BRANCH 135°

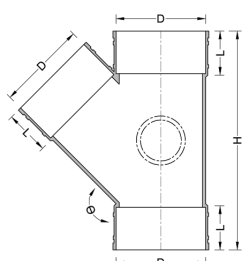

PRODUCT CODE	NOMINAL SIZE (mm)	DIMENSIONS (MM)			
		Angle (θ)	D	L	H
F-YB135-082-WT	82	135.00	82.60	205.00	45.30
F-YB135-110-WT	110	135.00	110.50	270.00	52.40
F-YB135-160-WT	160	135.00	160.40	373.00	73.30
F-YB135-200-WT	200	135.00	200.40	428.00	61.20
*F-O-YB135-250-WT	250	135.00	250.80	465.00	80.00
*F-O-YB135-315-WT	315	135.00	315.90	562.00	90.00

*Special order items are available on request.

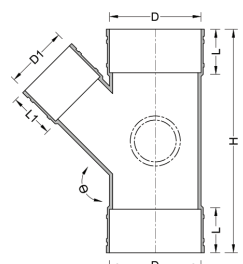

REDUCING Y-BRANCH 135°

PRODUCT CODE	NOMINAL SIZE (mm)	DIMENSIONS (MM)				
		D	D1	H	L	L1
F-RYB135-160X110-WT	160X110	160.80	110.60	306.00	74.40	52.90

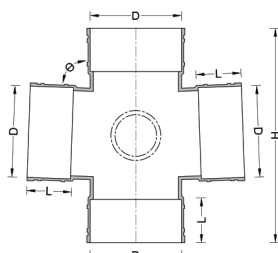

CROSS TEE (unswept)

PRODUCT CODE	NOMINAL SIZE (mm)	DIMENSIONS (MM)			
		Angle (θ)	D	L	H
F-CT-160-WT	160	87.50	160.50	70.00	315.00

PVC-U SWV & RAINWATER FITTINGS

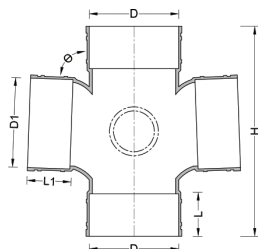

CROSS TEE 90° [F/F]

PRODUCT CODE	NOMINAL SIZE (mm)	DIMENSIONS (MM)				
		D	D1	H	L	L1
F-CT-110-WT	110	90.00	110.50	110.50	250.00	52.40

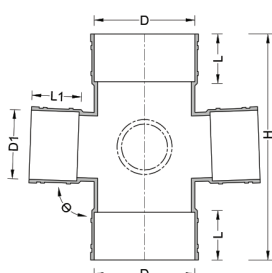

REDUCING CROSS TEE 90° [F/F]

PRODUCT CODE	NOMINAL SIZE (mm)	Angle (°)	DIMENSIONS (MM)				
			D	D1	L	L2	H
F-RCT-160X110-WT	160X110	87.50	160.50	110.40	315.00	50.00	74.00
F-RCT-200X110-WT	200X110	87.50	200.80	110.50	403.00	52.40	81.50
F-RCT-200X160-WT	200X160	87.50	200.80	160.70	403.00	74.00	81.50

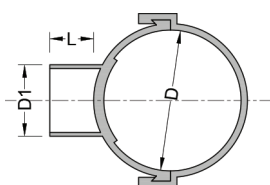

BOSS CONNECTOR

PRODUCT CODE	NOMINAL SIZE (mm)	DIMENSIONS (MM)		
		D	D1	L
F-BC-082X056-WT	82X56	82.80	56.00	30.40
F-BC-110X056-WT	110X56	110.40	56.00	34.30
F-BC-110X082-WT	110X82	110.40	82.70	40.80
F-BC-160X082-WT	160X82	160.50	82.80	44.70
F-BC-160X110-WT	160X110	160.50	110.30	51.50
F-BC-200X110-WT	200X110	200.70	110.50	48.00
F-BC-200X160-WT	200X160	200.70	160.70	58.00

STRAIGHT COUPLING

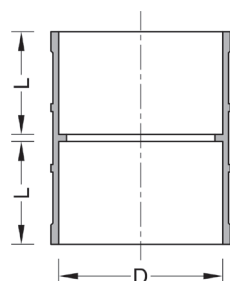

PRODUCT CODE	NOMINAL SIZE (mm)	DIMENSIONS (MM)	
		D	L
F-SC-036-WT	36	36.30	26.60
F-SC-043-WT	43	43.00	28.60
F-SC-056-WT	56	56.10	32.00
F-SC-082-WT	82	82.80	46.00
F-SC-110-WT	110	110.50	53.20
F-SC-160-WT	160	160.50	78.20
F-SC-200-WT	200	200.70	81.00
F-SC-250-WT	250	250.70	83.40
F-SC-315-WT	315	315.90	101.20

PVC-U SWV & RAINWATER FITTINGS

LEVEL INVERT REDUCING SOCKET

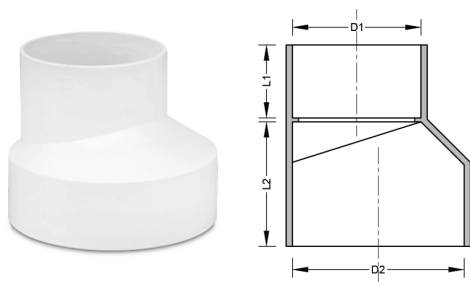

PRODUCT CODE	NOMINAL SIZE (mm)	DIMENSIONS (MM)			
		D1	D2	L1	L2
F-LIRS-110X082-WT	110X82	82.70	110.50	48.00	54.30
F-LIRS-160X110-WT	160X110	110.30	160.50	47.80	52.20
F-LIRS-200X110-WT	200X110	110.50	200.90	62.80	68.80
F-LIRS-200X160-WT	200X160	160.30	200.60	63.60	68.60
F-LIRS-250X110-WT	250X110	110.60	250.70	52.00	84.00
F-LIRS-250X160-WT	250X160	160.60	250.70	61.40	84.00
F-LIRS-250X200-WT	250X200	200.45	250.70	72.00	84.00
*F-O-LIRS-315X200-WT	315X200	315.90	200.60	90.00	72.00
*F-O-LIRS-315X250-WT	315X250	315.90	250.80	90.00	80.00

*Special order items are available on request.

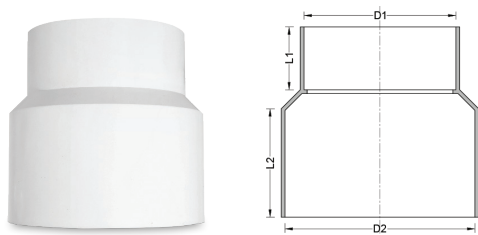

CONCENTRIC REDUCING SOCKET

PRODUCT CODE	NOMINAL SIZE (mm)	DIMENSIONS (MM)			
		D1	D2	L1	L2
F-CRS-250X200-WT	250X200	200.40	250.60	83.30	143.50

PIPE SLEEVE

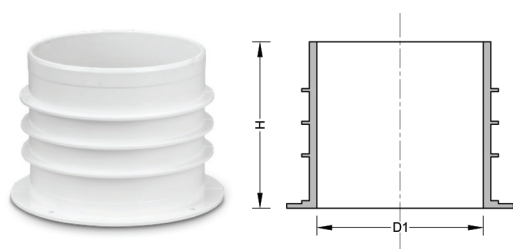

PRODUCT CODE	NOMINAL SIZE (mm)	DIMENSIONS (MM)	
		D1	H
F-PS-036-WT	36	36.50	110.20
F-PS-043-WT	43	43.10	110.20
F-PS-056-WT	56	56.10	110.00
F-PS-082-WT	82	82.80	95.50
F-PS-110-WT	110	110.50	104.00
F-PS-160-WT	160	160.70	158.30
F-PS-200-WT	200	200.70	171.00
*F-C-PS-250-WT	250	250.50	166.00
*F-C-PS-315-WT	315	316.00	208.00

*Special order items are available on request.

PVC-U SWV & RAINWATER FITTINGS

REDUCING BUSH

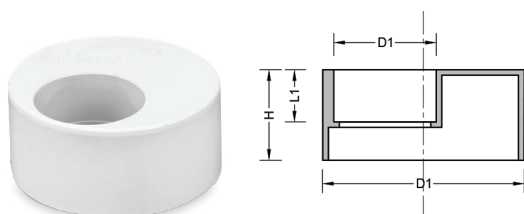

PRODUCT CODE	NOMINAL SIZE (mm)	DIMENSIONS (MM)			
		D	D1	H	H1
F-RB-043X036-WT	43X36	42.90	36.30	22.20	18.30
F-RB-056X036-WT	56X36	55.90	36.40	28.30	18.50
F-RB-056X043-WT	56X43	55.90	42.90	28.20	22.70
F-RB-082X056-WT	82X56	82.70	56.00	38.00	28.50
F-RB-110X056-WT	110X56	110.10	56.10	49.80	28.70
F-RB-110X082-WT	110X82	110.10	82.80	49.30	37.80
F-RB-160X110-WT	160X110	160.10	110.40	77.40	49.70
F-RB-200X110-WT	200X110	200.30	110.20	57.50	54.40
F-RB-200X160-WT	200X160	200.30	160.50	57.50	54.30
F-RB-250X110-WT	250X110	250.60	110.40	90.00	48.00
F-RB-250X160-WT	250X160	250.60	160.60	90.00	58.00
F-RB-250X200-WT	250X200	250.60	200.70	90.00	68.00
F-RB-315X110-WT	315X110	315.65	110.40	90.00	48.00
F-RB-315X160-WT	315X160	315.65	160.60	90.00	58.00
F-RB-315X200-WT	315X200	315.65	200.70	90.00	68.00
F-RB-315X250-WT	315X250	315.65	250.70	90.00	80.00

END CAP

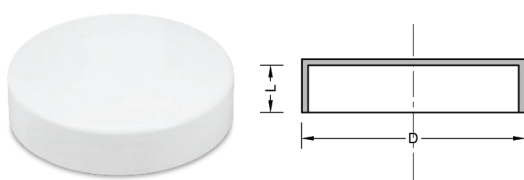

PRODUCT CODE	NOMINAL SIZE (mm)	DIMENSIONS (MM)	
		D	L
F-EC-056-WT	56	56.00	28.20
F-EC-082-WT	82	83.00	45.00
F-EC-110-WT	110	110.40	23.50
F-EC-160-WT	160	160.30	77.50
F-EC-200-WT	200	200.60	90.00
*F-C-EC-250-WT	250	250.70	110.00
*F-C-EC-315-WT	315	315.90	125.00

*Special order items are available on request.

PVC-U SWV & RAINWATER FITTINGS

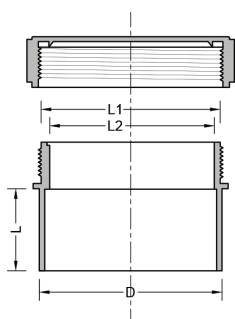

ACCESS PLUG INSERT (SCREW REMOVABLE)

PRODUCT CODE	NOMINAL SIZE (mm)	DIMENSIONS (MM)			
		D	L	L1	L2
*F-O-API-043-WT	43	43.00	21.00	42.90	-
*F-O-API-056-WT	56	56.00	31.00	55.90	-
*F-O-API-082-WT	82	82.00	45.00	82.60	-
F-API-110-WT	110	110.20	49.30	100.00	97.70
*F-O-API-160-WT	160	160.00	78.00	160.20	-

*Special order items are available on request.

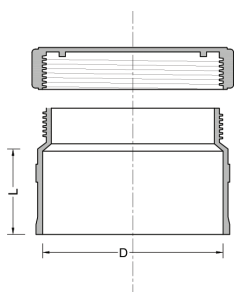

ACCESS PLUG SOCKET (SCREW REMOVABLE)

PRODUCT CODE	NOMINAL SIZE (mm)	DIMENSIONS (MM)	
		D	L
F-APS-160-WT	160	160.60	75.50
*F-O-APS-200-WT	200	200.60	186.00
*F-O-APS-250-WT	250	250.70	242.00
*F-O-APS-315-WT	315	315.90	244.00

*Special order items are available on request.

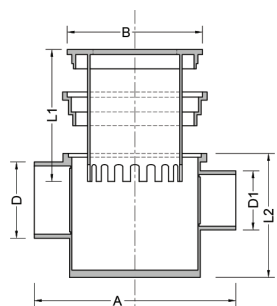

FLOOR GULLY GRATING SET

PRODUCT CODE	SIZE (mm)	DIMENSIONS (mm)						
		L	L1	L2	A	B	D	D1
F-FGGS-110X056-WT	110X56	166.00	118.00	111.00	32.00	119.00	56.00	43.00

PVC-U SWV & RAINWATER FITTINGS

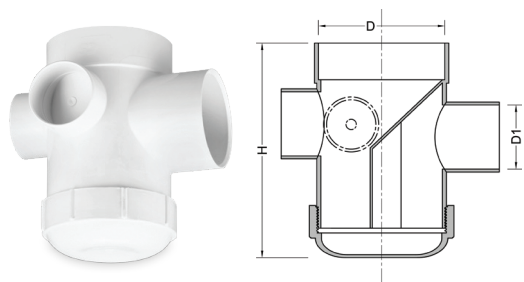

FLOOR GULLY WITH TRAP I/O

PRODUCT CODE	NOMINAL SIZE (mm)	DIMENSIONS (MM)		
		D	D1	H
F-FGIO-110X056-WT	110X56	110.40	56.00	188.00
F-FGIO-110X082-WT	110X82	110.40	83.00	188.00

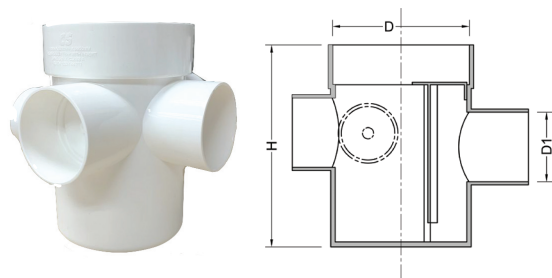

FLOOR GULLY TRAP WITH INSERT

PRODUCT CODE	NOMINAL SIZE (mm)	DIMENSIONS (MM)		
		D	D1	H
F-FGIO-110X056-WT	110X56	110.60	56.20	163.50
F-FGIO-110X082-WT	110X82	110.60	83.00	163.50

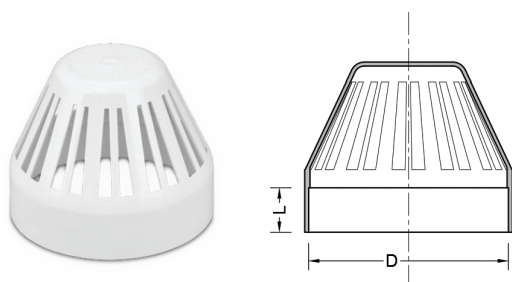

VENT COWL

PRODUCT CODE	NOMINAL SIZE (mm)	DIMENSIONS (MM)	
		D	L
F-VC-056-WT	56	56.00	31.00
F-VC-082-WT	82	82.80	25.00
F-VC-110-WT	110	110.60	25.00

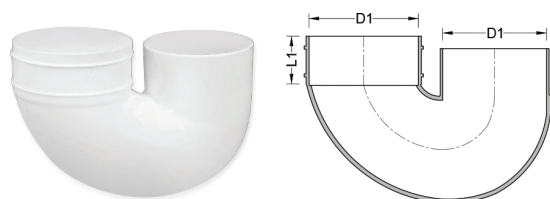

U-BODY

PRODUCT CODE	NOMINAL SIZE (mm)	DIMENSIONS (MM)	
		D1	L1
F-UB-110-WT	110	110.40	46.50

PVC-U SWV & RAINWATER FITTINGS

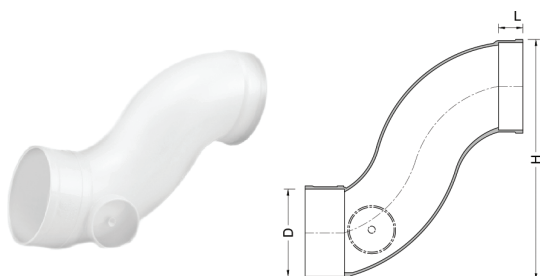

SWAN NECK

PRODUCT CODE	NOMINAL SIZE (mm)	DIMENSIONS (MM)		
		D	L	H
F-SWN-100-WT	110	110.50	50.00	280.00

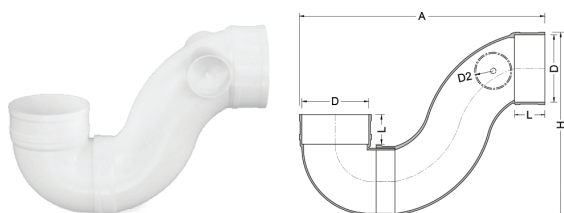

P-TRAP

PRODUCT CODE	NOMINAL SIZE (mm)	DIMENSIONS (MM)				
		D	D2	L	A	H
F-PTR-056-WT	56	56.00	-	32.20	242.00	192.00
F-PTR-110-WT	110	110.40	56.00	49.50	375.00	270.00

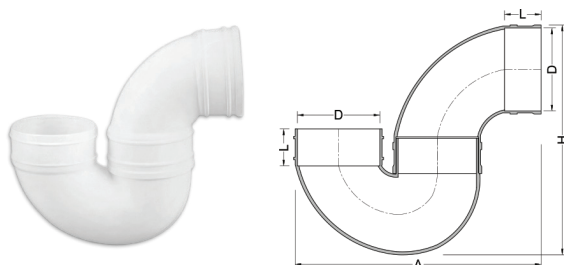

P-TRAP (U-BODY)

PRODUCT CODE	NOMINAL SIZE (mm)	DIMENSIONS (MM)			
		D	L	A	H
F-PTR-UB-110-WT	110	110.40	46.50	310.00	295.00

PVC-U SWV & RAINWATER FITTINGS

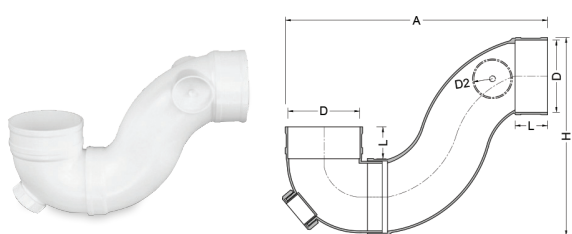

P-TRAP WITH I/O

PRODUCT CODE	NOMINAL SIZE (mm)	DIMENSIONS (MM)			
		D	H	A	H
F-PTRIO-056-WT	56	56.00	32.20	242.00	192.00
F-PTRIO-110-WT	110	110.40	49.50	375.00	270.00

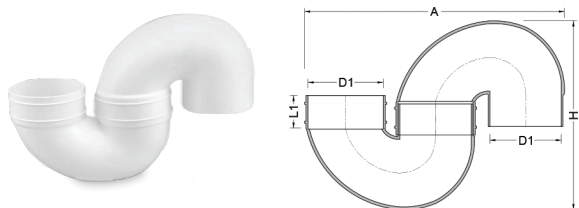

S-TRAP (U-BODY)

PRODUCT CODE	NOMINAL SIZE (mm)	DIMENSIONS (MM)			
		D1	L1	A	H
F-STR-UB-110-WT	110	110.40	46.50	380.00	280.00

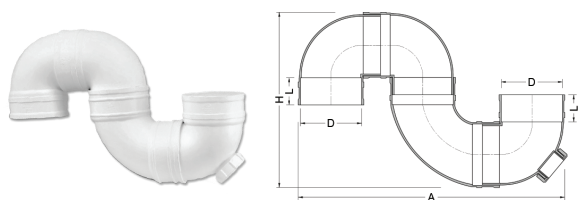

S-TRAP WITH I/O

PRODUCT CODE	NOMINAL SIZE (mm)	DIMENSIONS (MM)			
		D1	L1	A	H
F-STRIO-110-WT	110	110.40	46.50	380.00	280.00

PVC-U SWV & RAINWATER FITTINGS

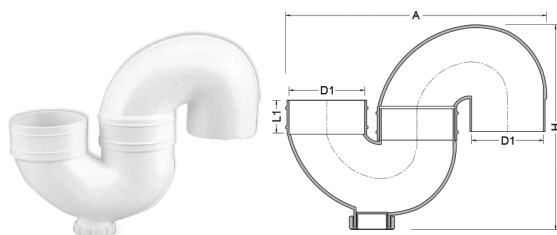

S-TRAP WITH I/O (U-BODY)

PRODUCT CODE	NOMINAL SIZE (mm)	DIMENSIONS (MM)			
		D1	L1	A	H
F-STRIO-UB-110-WT	110	110.40	46.50	380.00	280.00

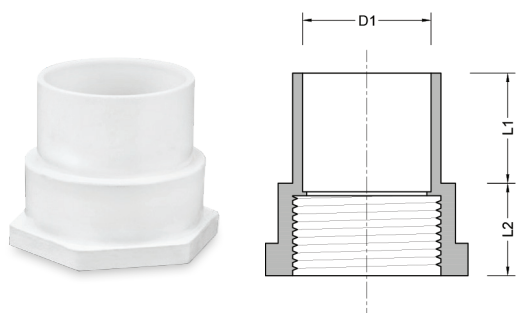

FAUCET SOCKET

PRODUCT CODE	NOMINAL SIZE (mm)	DIMENSIONS (MM)		
		D1	L1	L2
F-FS-036-WT	36	36.30	32.60	26.00
F-FS-043-WT	43	43.00	36.00	34.80

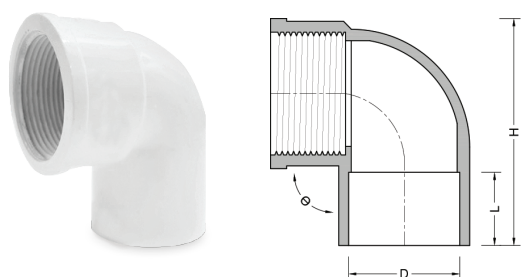

FAUCET BEND 90°

PRODUCT CODE	NOMINAL SIZE (mm)	DIMENSIONS (MM)			
		Angle (θ)	D	H	L
F-FB90-043-WT	43	90.00	43.20	90.10	29.00

PVC-U SOIL, WASTE, VENT ASSEMBLY SYSTEM



Solvent Cement is a cost-effective and highly secure method for pipe assembly. It can be used on PVC-U pipes and socket-end pipes. CS's Solvent Cement is recommended for use on PVC and PVC-U pipes. It features superior adhesion, fast setting, and waterproof bonding. Upon full cure, it is safe for drinking water, irrigation, wastewater, sanitary pipes, conduits, and more.

Features:

- ◆ Reliable and highly secure bonding
- ◆ Cost-effective as a small amount is needed for each application
- ◆ Strong resistance to vibration and pulsation leaks
- ◆ Watertight adhesion
- ◆ Fast setting and easy installation



POLYVINYL CHLORIDE (PVC) SOLVENT CEMENT

CS solvent cement is a formulated premium-quality liquid adhesive used to create an airtight seal for PVC-U pipes and fittings. Our solvent cement features strong bonding strength, fast-dry, slow-dry, and waterproof sealing properties. It is safe for drinking-water supply piping, sanitary pipes, water irrigation, and more. All our solvent cements are certified by SIRIM QAS International in compliance with MS 628-4:2015 (equivalent to British Standard BS 4346 Part 3).



Product Code: SSCPVC500-T
Colour: Transparent (Fast Dry)
Solid consists of: MEK & CYC



Product Code: SSCPVC500-G
Colour: Transparent (Fast Dry)
Solid consists of: MEK & CYC



Product Code: SSCPVC500-B
Colour: Transparent (Slow Dry)
Solid consists of: MEK, CYC & thf

Solid content: 24%
Consistency property: 1,000 pcs

Quality: Tough & Resistance
Comply to Standard : MS 628-4:2015

- ♦ A highly soluble **FAST DRY** and **SLOW DRY** PVC-U Solvent Cement available.
- ♦ When applied, it will instantly dissolve and blend with the pipe to produce a film (wall) of 0.4mm thick, so that the fitting gap will be strong and stable.

RECOMMENDATIONS ON BRUSH :-

A : Pipes with diameter 25mm (1") and below – use the brush provided with the can.

B : Pipes with diameter 32mm to 50mm (1 1/4" to 2") – use 1" brush.

C : Pipes with diameter 75mm to 200mm (3" to 8" and above) – use 2" brush.

PRESSURE TEST

Cold Water (20°C)

Hot Water (60°C)

TEST PRESSURE

Below 12kg/cm²(171psi)

Below 12kg/cm²(171psi)

DRYING TIME

After 1 hour

After 2 hour

MATERIAL SAFETY DATA SHEET

COMPOSITION/INFORMATION ON INGREDIENT:

Ingredient	PVC Resin	Cyclohexanone	Methyl Isobuty Ketone (MIBK)	T.H.F.	Methyl Ethynl Keltone (MEK)
CAS No.	9003-22-9	108-94-1	141-79-7	109-99-9	78-93-3
% - volume	24%	30%	11%	4%	55%

ESTIMATED SOLVENT CEMENT REQUIREMENT:-

NOMINAL/SIZES		NUMBER OF POSSIBLE JOINTS 500g
(IN.)	(MM)	
1/2	15	383
3/4	20	250
1	25	200
1 1/4	32	156

NOMINAL/SIZES		NUMBER OF POSSIBLE JOINTS 500g
(IN.)	(MM)	
1 1/2	40	100
2	50	69
3	80	41
4	100	32

NOMINAL/SIZES		NUMBER OF POSSIBLE JOINTS 500g
(IN.)	(MM)	
6	155	19
8	200	10
10	250	6
12	300	4

PHYSICAL AND CHEMICAL PROPERTIES

Appearance : Clear Flash Point : 15°C DG Class : 3.2

Flammable Mixture (UN No. 1133)

This solvent cement material will ignite at ambient temperatures. Colourless vapors may travel considerable distance to ignition sources and cause flash fires or explosions.

HAZARD IDENTIFICATION

May cause eyes and skin irritation, burns or dermatitis.

STORAGE

Store in well-ventilated area. Keep away from heat, sparks and flame.

SAFETY PHASE

- Kep away from sources of ignition - No-Smoking.
- Avoid contact with eyes.
- In case of fire, use chemical powder, foam or carbon dioxide.

INSTALLATION GUIDE



Preparation

Prepare all the needed tools and equipment for the pipe installation.



Marking

Mark the socket depth on the pipe end.



Cutting the Pipe

Cut the pipe with the proper tool, using a fine-toothed saw.



Joint Preparation

Slightly deburr the external pipe edge and break off any sharp edges.



Cleaning

Thoroughly clean all surfaces to be joined. Any dirt, moisture, oil and other foreign material will affect the joining's integrity.



Test Dry Fit of the joint

Insert the spigot into the socket without the solvent cement to check the fit. An interference fit should occur between 1/3 and 2/3 of full entry.



Witness Mark the pipe

Draw a line on the spigot to show the depth of the socket.



Apply Solvent Cement on Pipe

Apply an even coat of solvent to the pipe marked for joining.



Apply Solvent Cement on Fitting

Apply an even coat of solvent to the inside of the spigot or socket.



Assembly of joint

While both parts to be joined are still wet, put the spigot into the socket in a slightly twisting motion. Hold the cemented joint idle for a minimum of 30 seconds for secure adhesion.



Clean off

Wipe off excess cement from the pipe at the end of the socket. Any gaps in the cement ring around the pipe perimeter may indicate a defective assembly.



OTHER CS CATALOGUES



**PVC-U Rainwater
Drainage System**

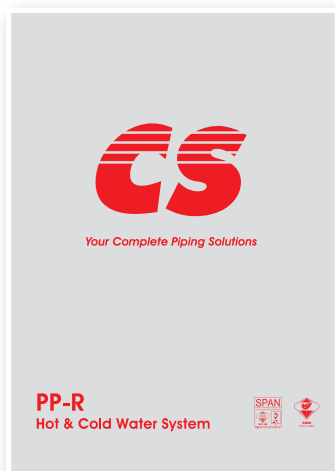

**PP-R Hot & Cold Water
System**

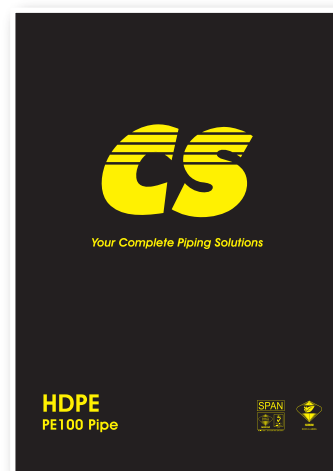

HDPE PE100 Pipe

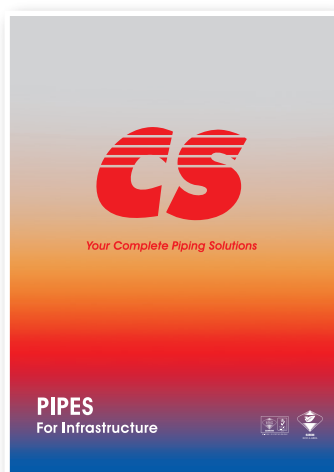

Pipes For Infrastructure

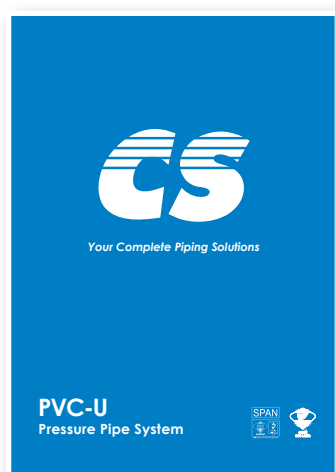

**PVC-U Pressure Pipe
System**



**PVC-U Underground
Sewerage System**



Your Complete Piping Solutions



Water Storage Tank, Waste Water Management
& Road Safety Management

CONTACT US

Tel: +605-201 1273

Fax: +605-201 1062

Email: cs@cewsin.com.my

Website: www.cewsin.com.my



Scan the QR code
to get **more & quick information**
from our new catalogue!

Disclaimer:

The information provided by Cew Sin Plastic Pipe Sdn. Bhd. in this catalogue is for general informational purposes only. All information in this catalogue is provided in good faith. However, we make no representation or warranty of any kind, express or implied, regarding the accuracy, adequacy, validity, reliability, or completeness of any information in this catalogue. Under no circumstance shall we have any liability to you for any loss or damage of any kind incurred as a result of the use of this information. Your use of the catalogue and your reliance on any information provided is solely at your own risk.